

PF105- TIMBER PALISADE FENCING 1.2M Installation Instructions

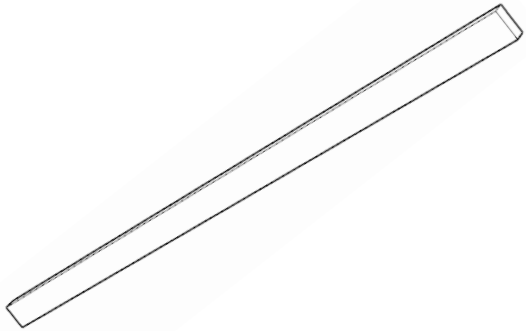

x3
HORIZONTAL TIMBER -PF105-A

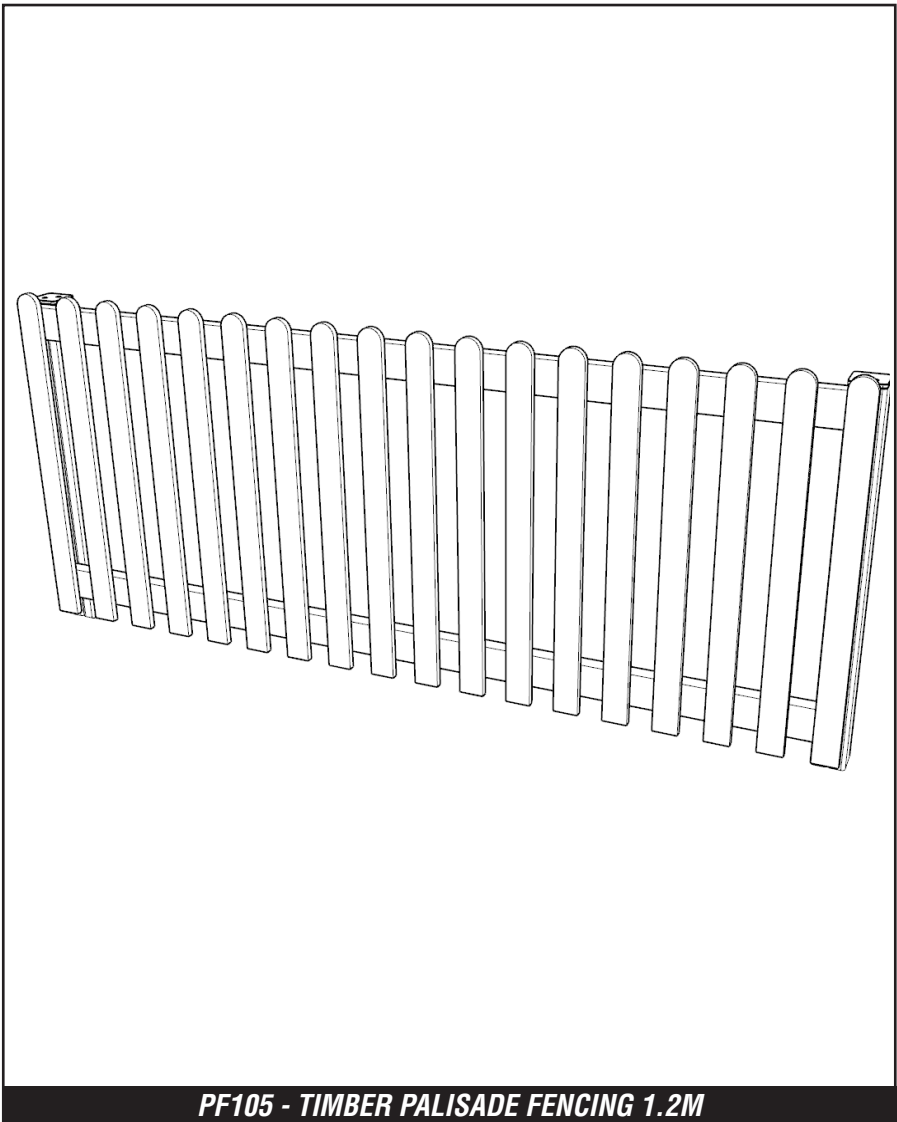
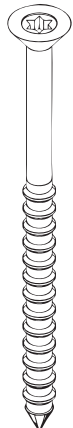

x12
M8X80



x108
M6X40



x18
SLATS

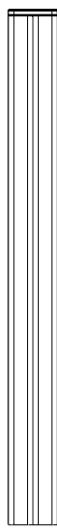

x2
UPRIGHTS -PF105-B

FOUNDATION DETAILS

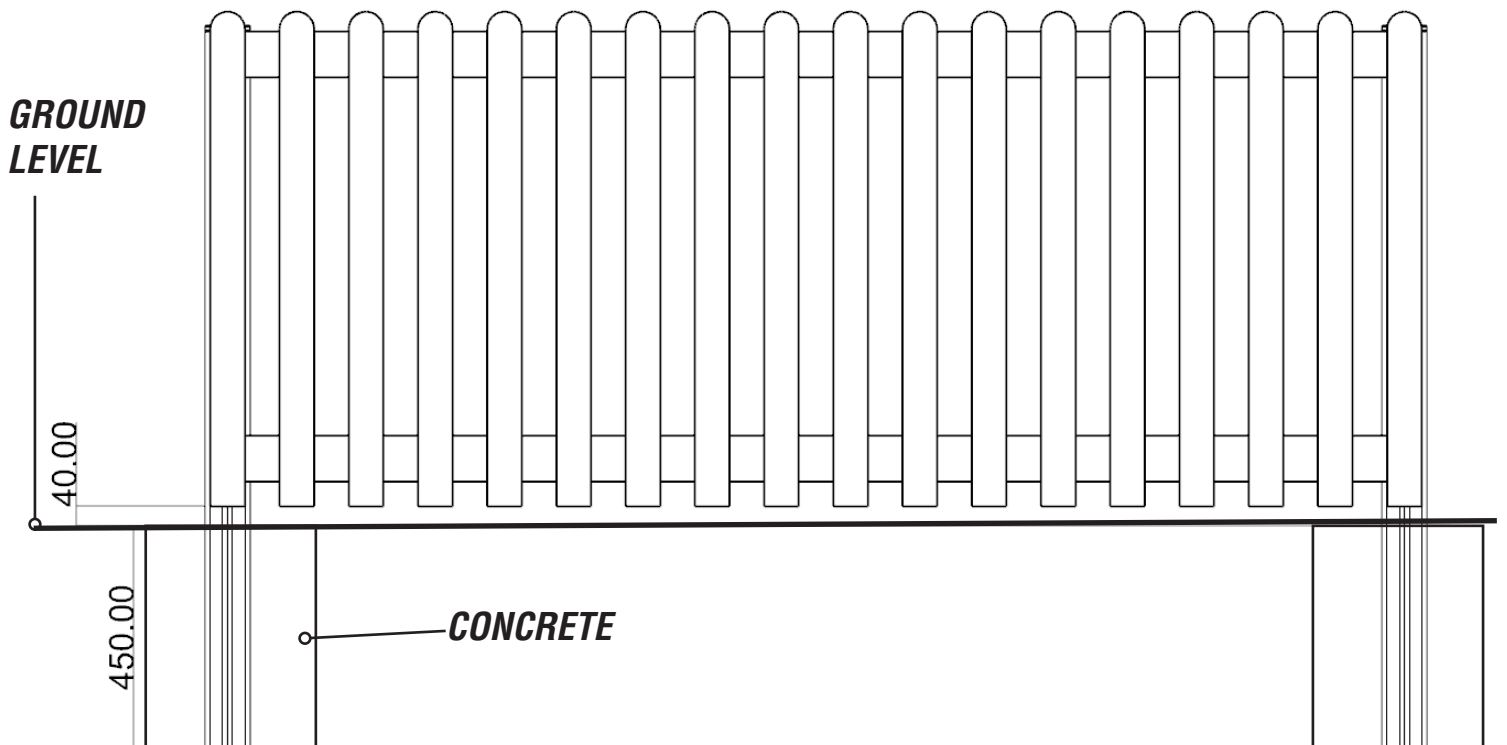
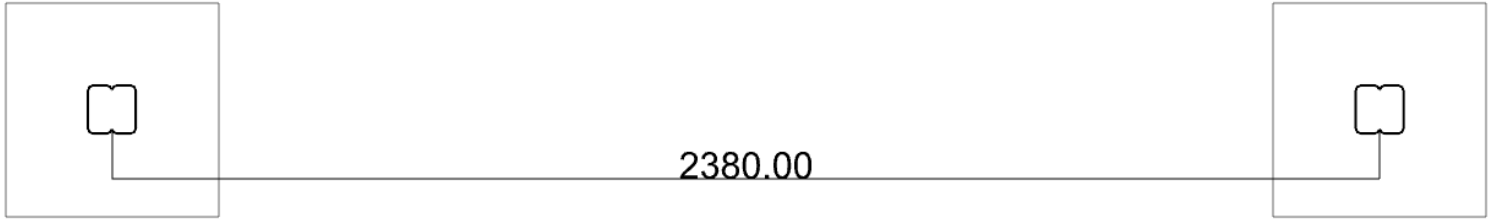

INSTALLATION INSTRUCTIONS

1 INSTALL UPRIGHTS INTO THE GROUND



2 POSITION THE GUARD RAIL / PANEL AS SHOWN BELOW USING - M8X80 [X12]

**SCREW TIMBER OFF CENTRE 45MM
USING M8X80 X8**

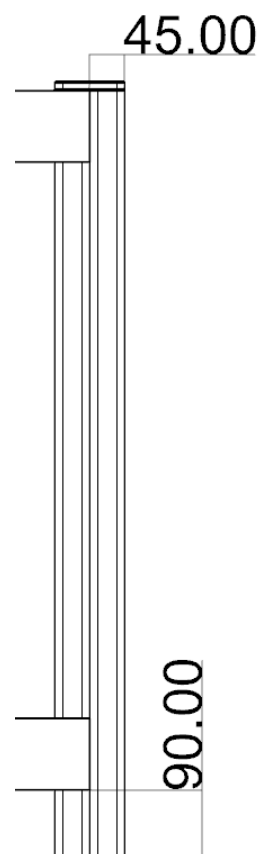
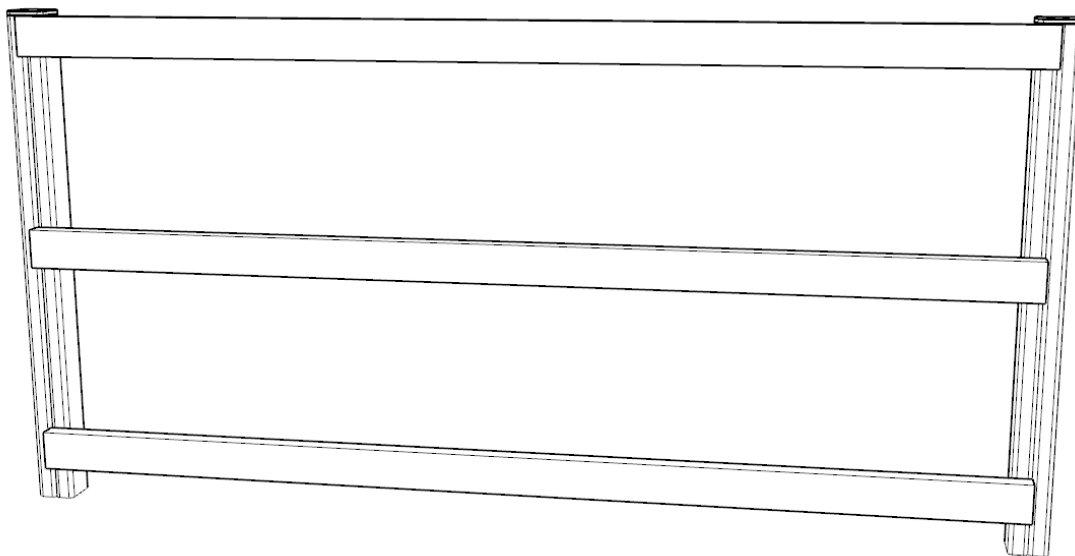

INSTALLATION INSTRUCTIONS

3 ATTACH SLATS TO THE FRAME USING M6 X 40 WOOD SCREWS [X108]

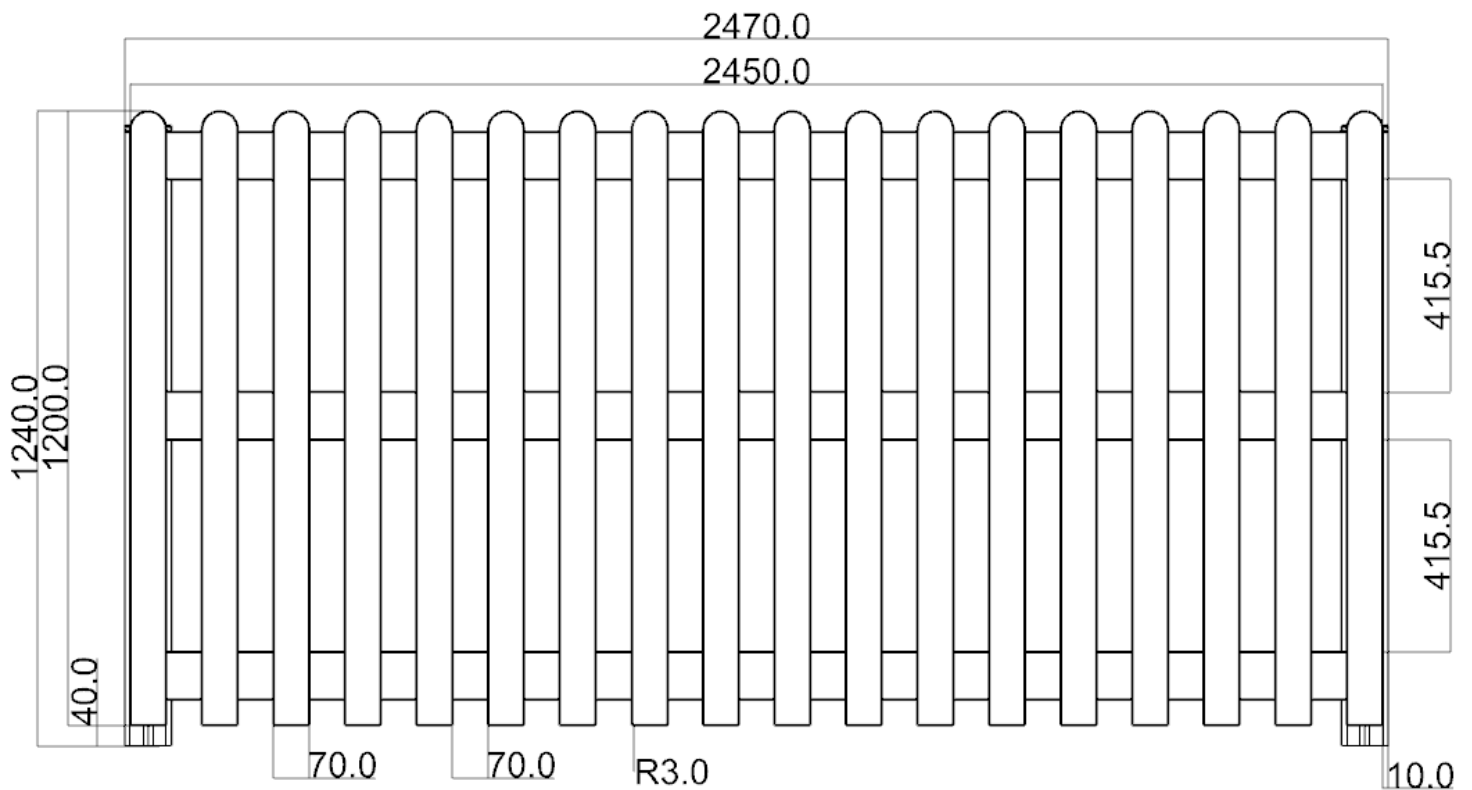
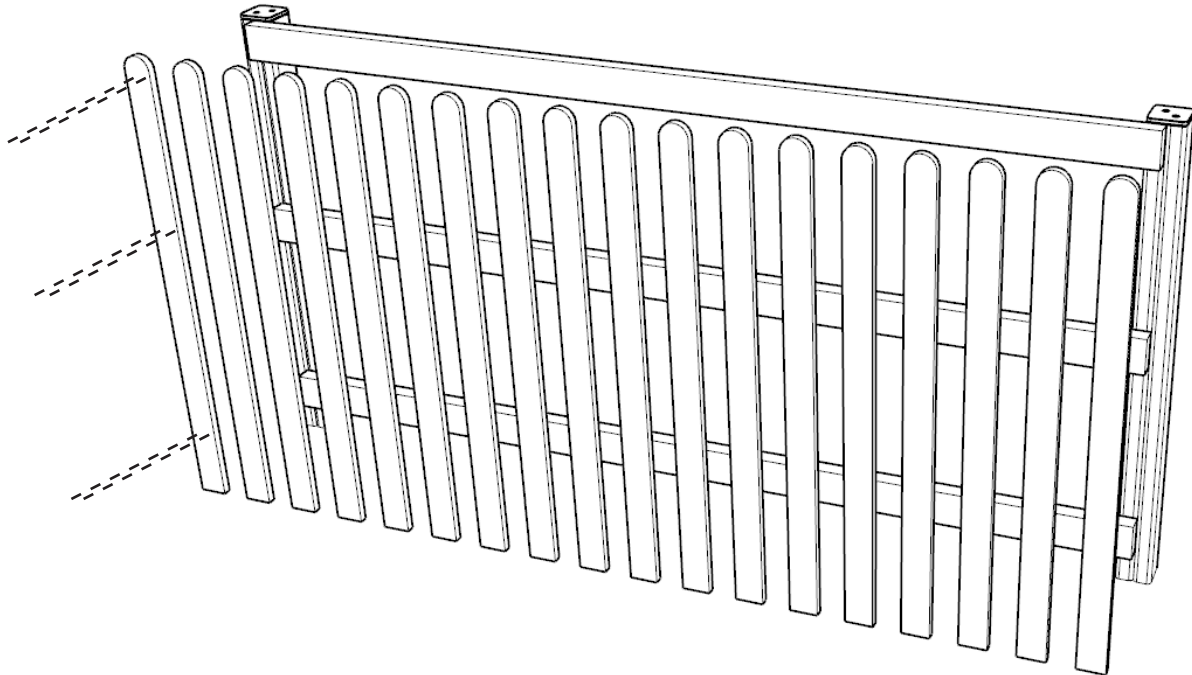

(SPACING BETWEEN SLATS 70MM)

ADDITIONAL DIMENSIONS

