

PB146 - SENSORY SNAKE PLAYBOARD

Installation Instructions

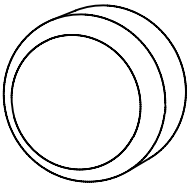
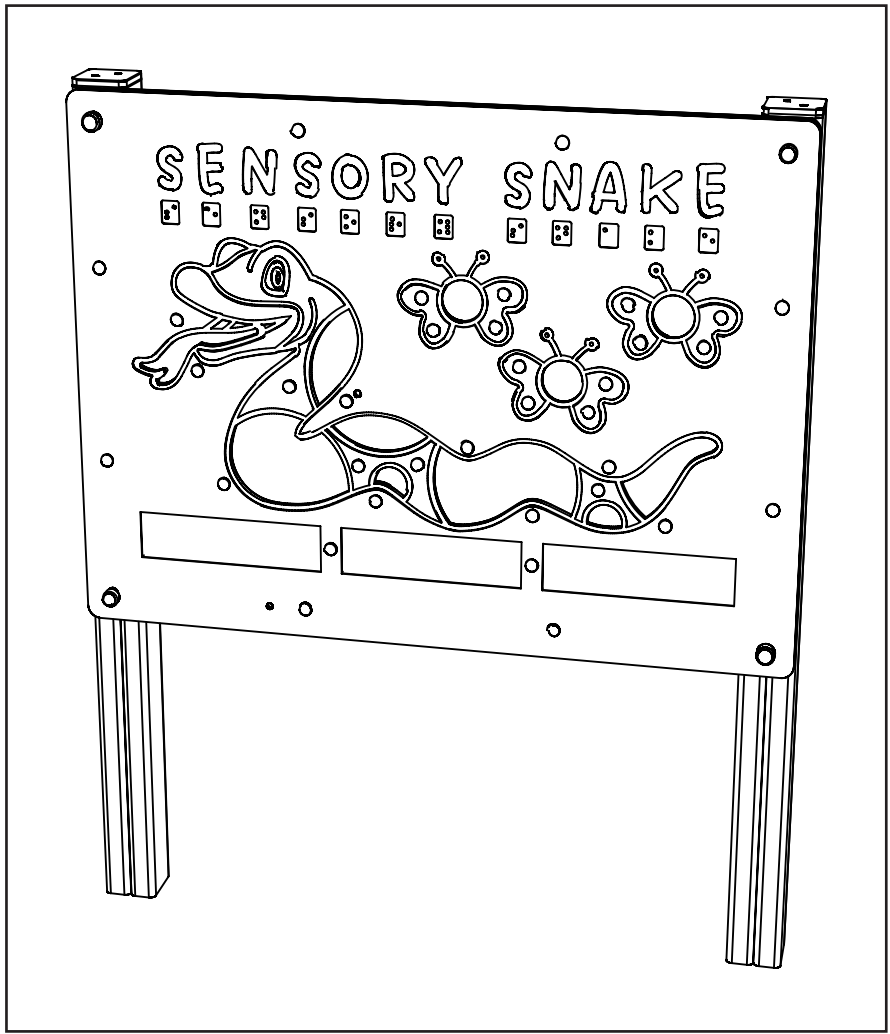

x4

M8 END CAP

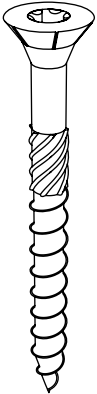

x4

97.M8X80CSK

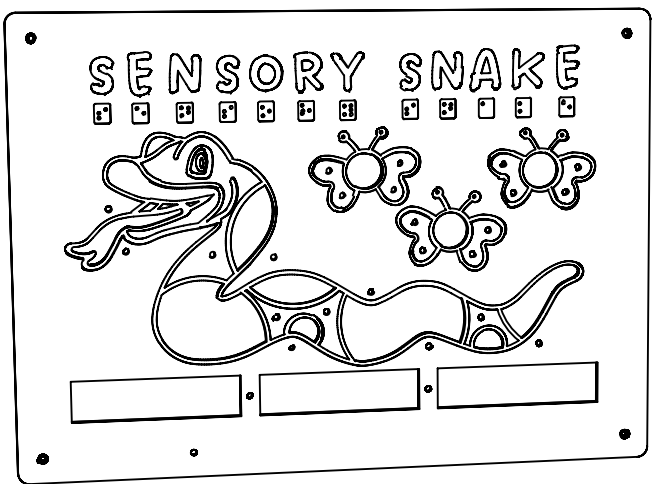

x1

JIGPB109 - SENSORY SNAKE PLAYBOARD

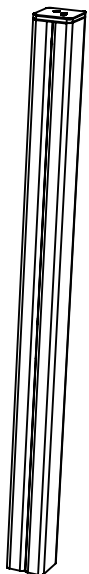

x2

TIMBER POST

INSTALLATION INSTRUCTIONS

1 ATTACH PLAYBOARD TO THE PLATFORM UPRIGHT TIMBERS USING M8X80CSK [X4]. (BLANK BOARD SHOWN FOR ILLUSTRATION ONLY)

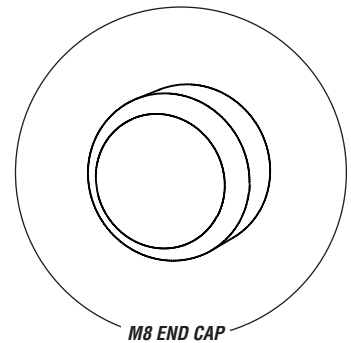
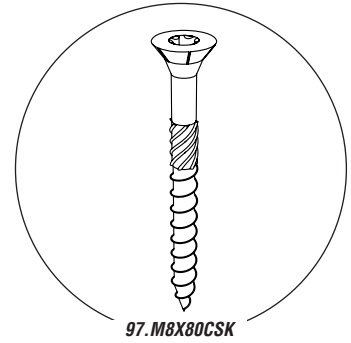
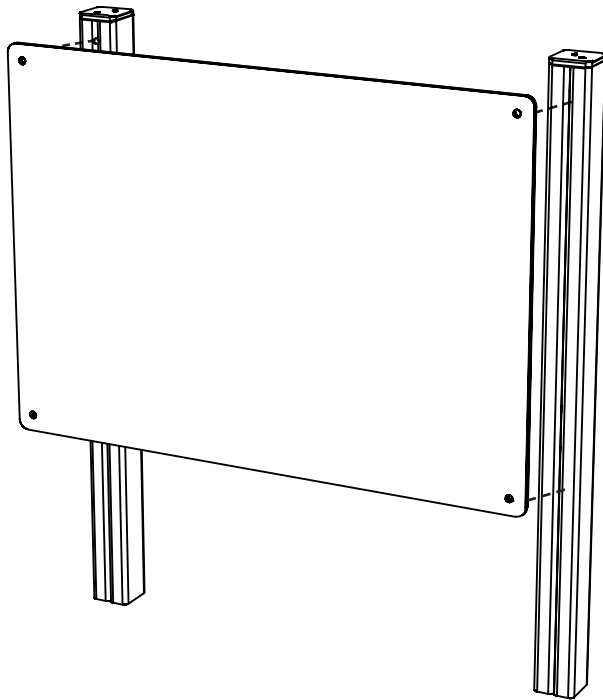

2 PLEASE NOTE POSITION THE PLAYBOARD AS SHOWN BELOW (BLANK BOARD SHOWN FOR ILLUSTRATION ONLY)

