

SG113 - BUG HOTEL

Installation Instructions

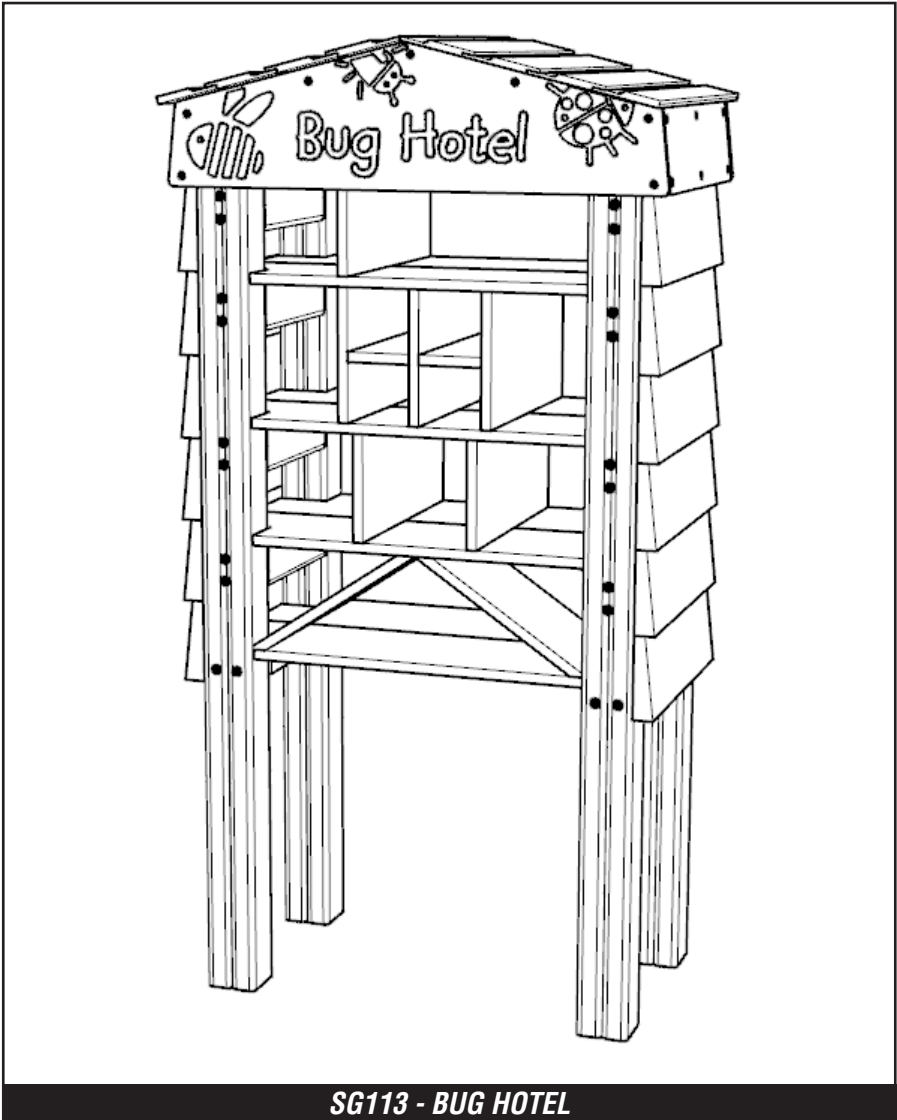

SG113 - BUG HOTEL

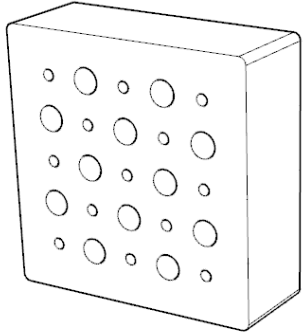

x4

BEE HOUSE BLOCKS

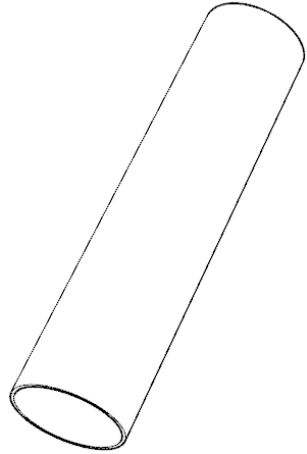

x4

ACRYLIC TUBES

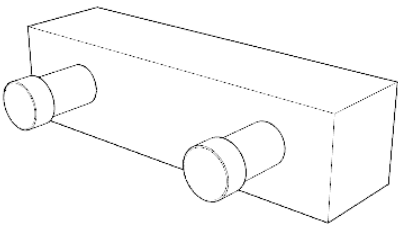

(2X LEFT & 2X RIGHT) x4

PANEL BLOCKS

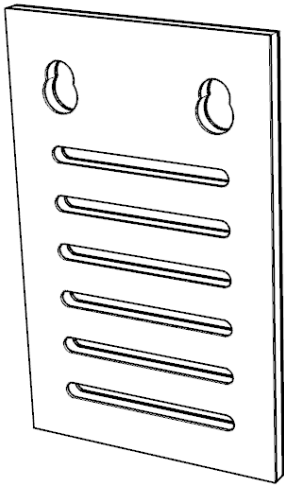

x2

GREENFLY PANEL

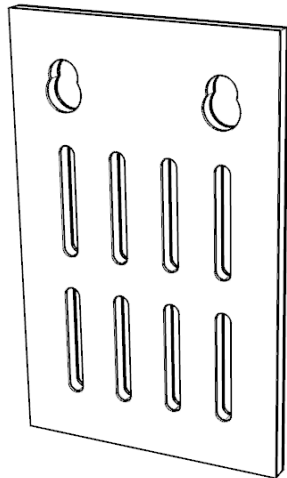

x2

BUTTERFLY PANEL

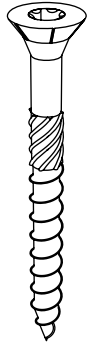

x8

M6X60MM WOOD SCREWS

FOUNDATIONS

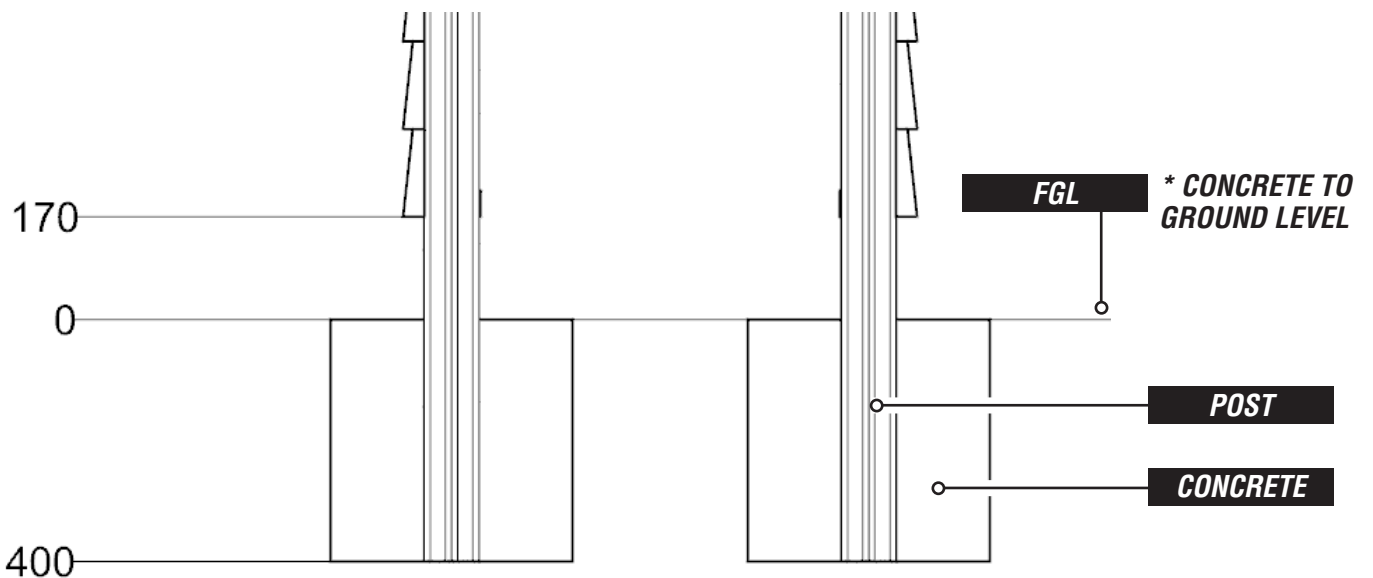
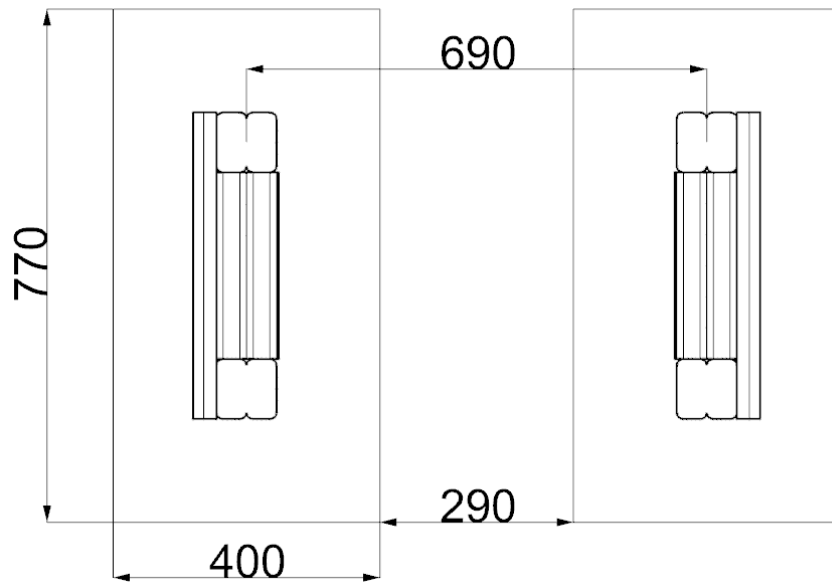

INSTALLATION INSTRUCTIONS

1

**INSTALL BUG HOTEL
ACCORDING TO GROUND PLAN**

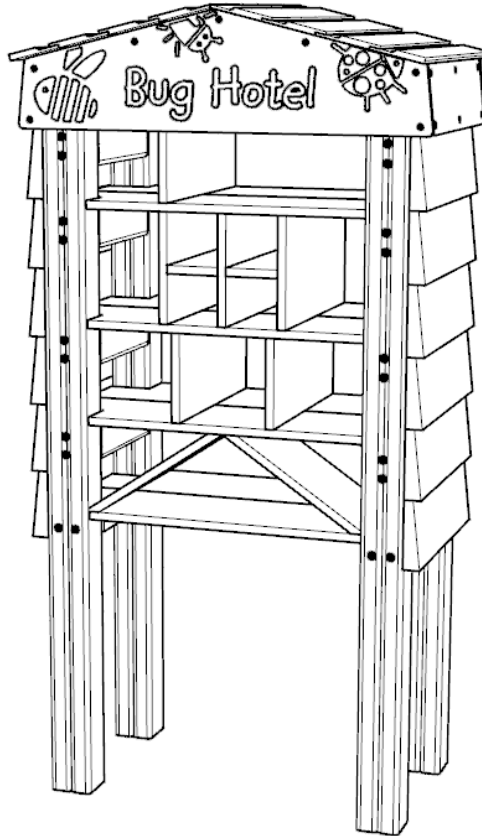

2

ATTACH PANEL BLOCKS TO SHELF SHOWN

USING M6X60MM WOOD SCREWS, SCREW INTO BLOCK FROM TOP OF SHELF ON BOTH SIDES - READ DIAGRAM!

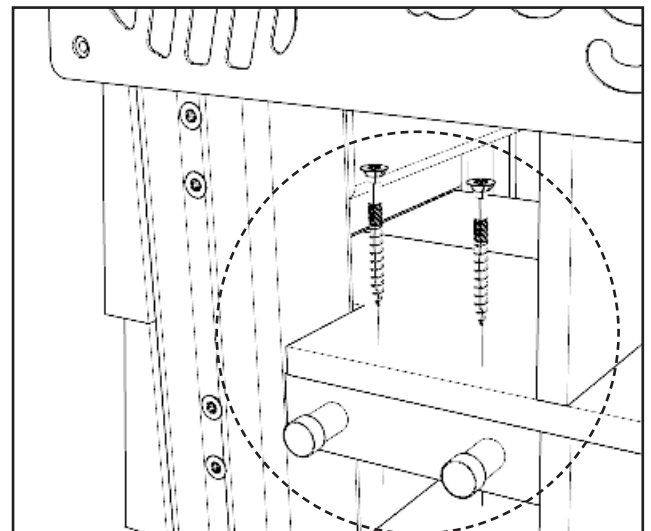
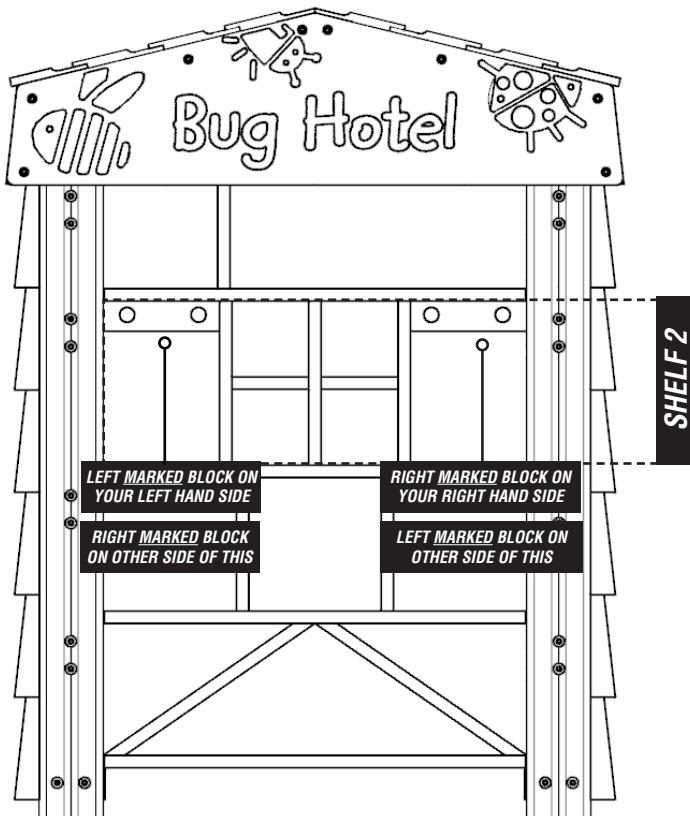

NOTES:

ENSURE THE SCREWS DO NOT CLASH WITH BOLTS IN BLOCKS AND IS FLUSH WITH SHELF EDGE

ENSURE SLEEVE CAP ENDS ARE ON OUTSIDE OF HOTEL

3

INSERT LOOSE PARTS INTO SHELF DIVIDERS

SEE DRAWING BELOW FOR LOOSE PART LOCATIONS, THIS PRODUCT IS 2 SIDED - LOOSE PARTS GO ON BOTH SIDES

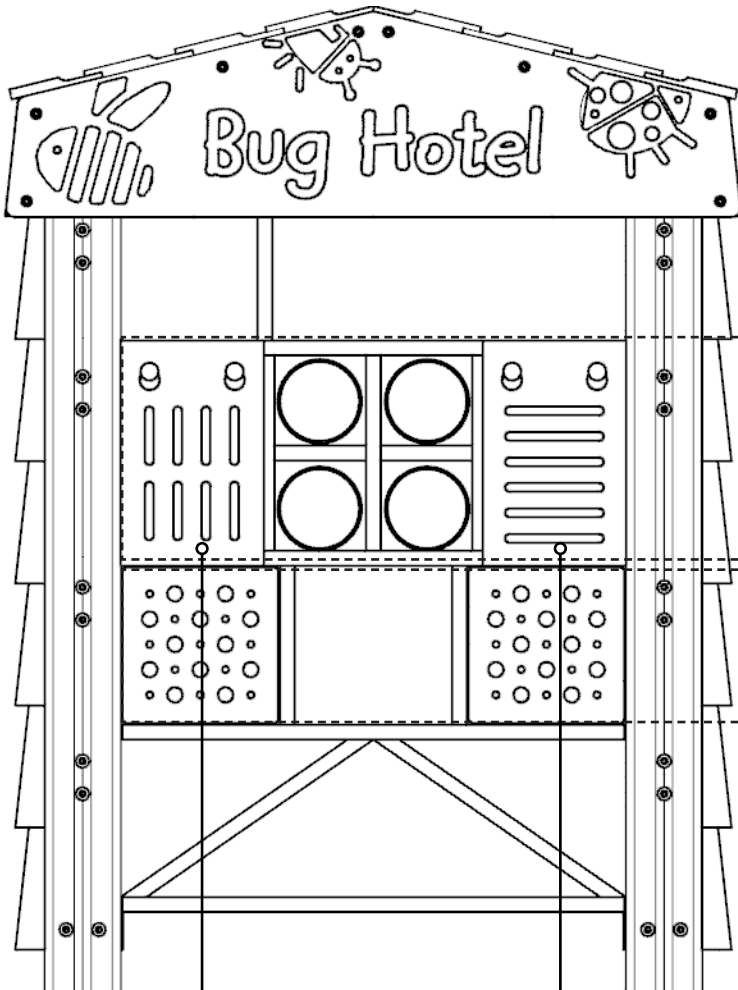

SHELF 2 LOOSE PARTS:

- 4X ACRYLIC TUBES
- 2X BUTTERFLY PANEL (HOOK ONTO SLEEVED BOLTS, ON ONE SIDE)
- 2X GREENFLY PANEL (HOOK ONTO SLEEVED BOLT, ON OTHER SIDE)

SHELF 3 LOOSE PARTS:

- 4X BEE HOUSE BLOCKS (POSITION FLUSH WITH SHELF EDGE ON BOTH SIDES)

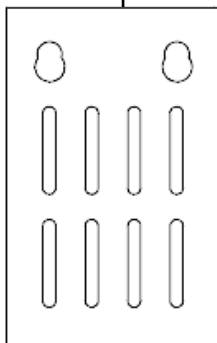

BUTTERFLY X2

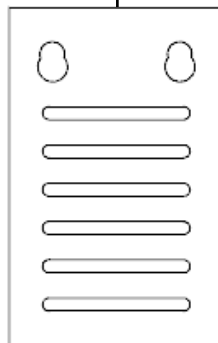

GREENFLY X2

ENSURE SAME PLAYTEC BUG PANELS ARE ON SAME SIDE (BACK TO BACK)

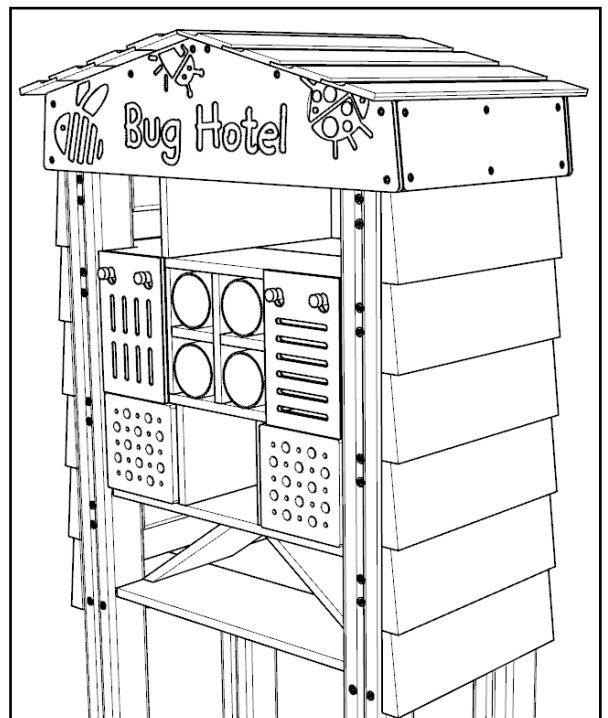

REF: SG113 - BUG HOTEL

ADDITIONAL DIMENSIONS

