

PP106 - POST OFFICE PLAYTOWN PANEL
Installation Instructions

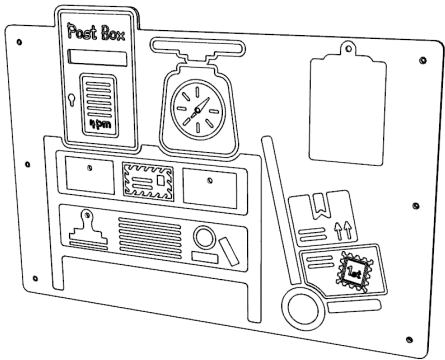

x1

UPPER PANEL



x1

SIDE PANEL

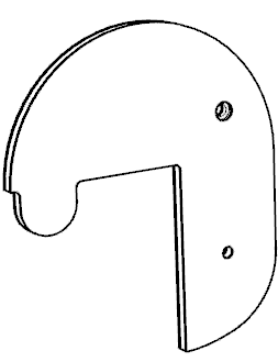

x2

LARGE BRACKETS

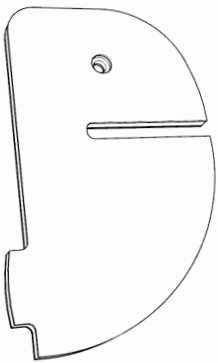

x2

SMALL BRACKETS

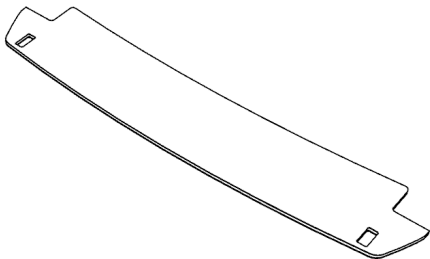

x1

ENGRAVED PLAYTEC SHELF

PARTS REQUIRED

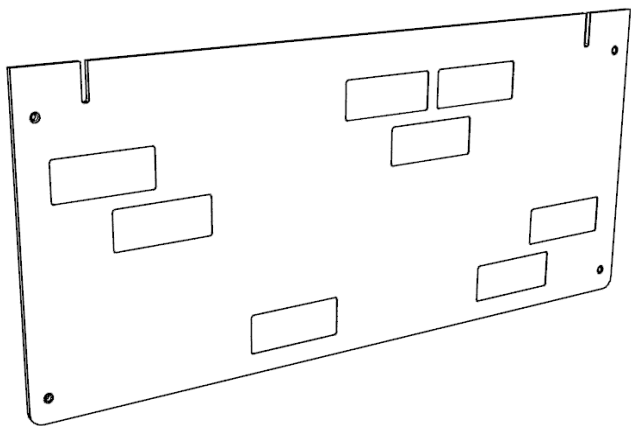

x1

LOWER PLAYTEC PANEL

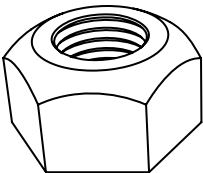

x4

M10 NUT

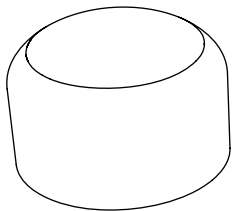

x4

102003-01

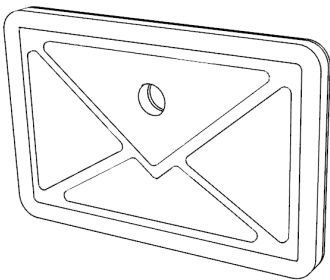

x2

LOOSE PART - ENVELOPE

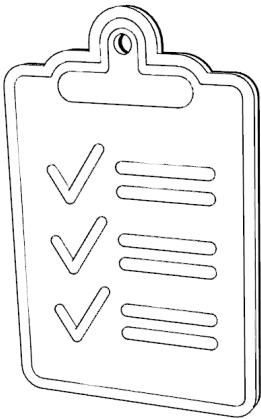

x4

LOOSE PART - CLIP BOARD

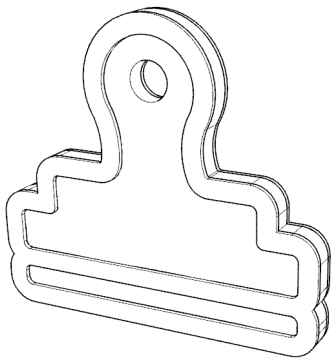

x1

LOOSE PART - STAMP

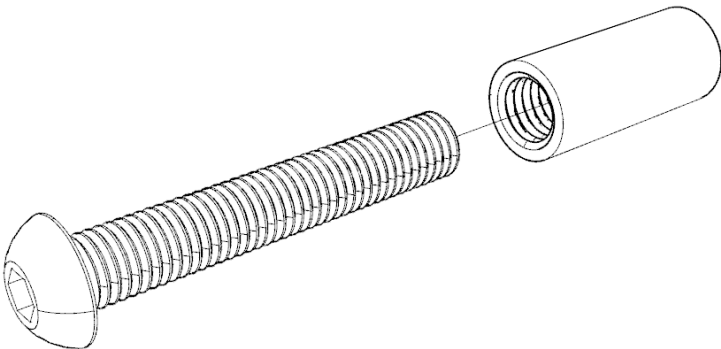

x4

M10X60MM SOCKET BUTTON BOLT WITH SLEEVE

FOUNDATIONS

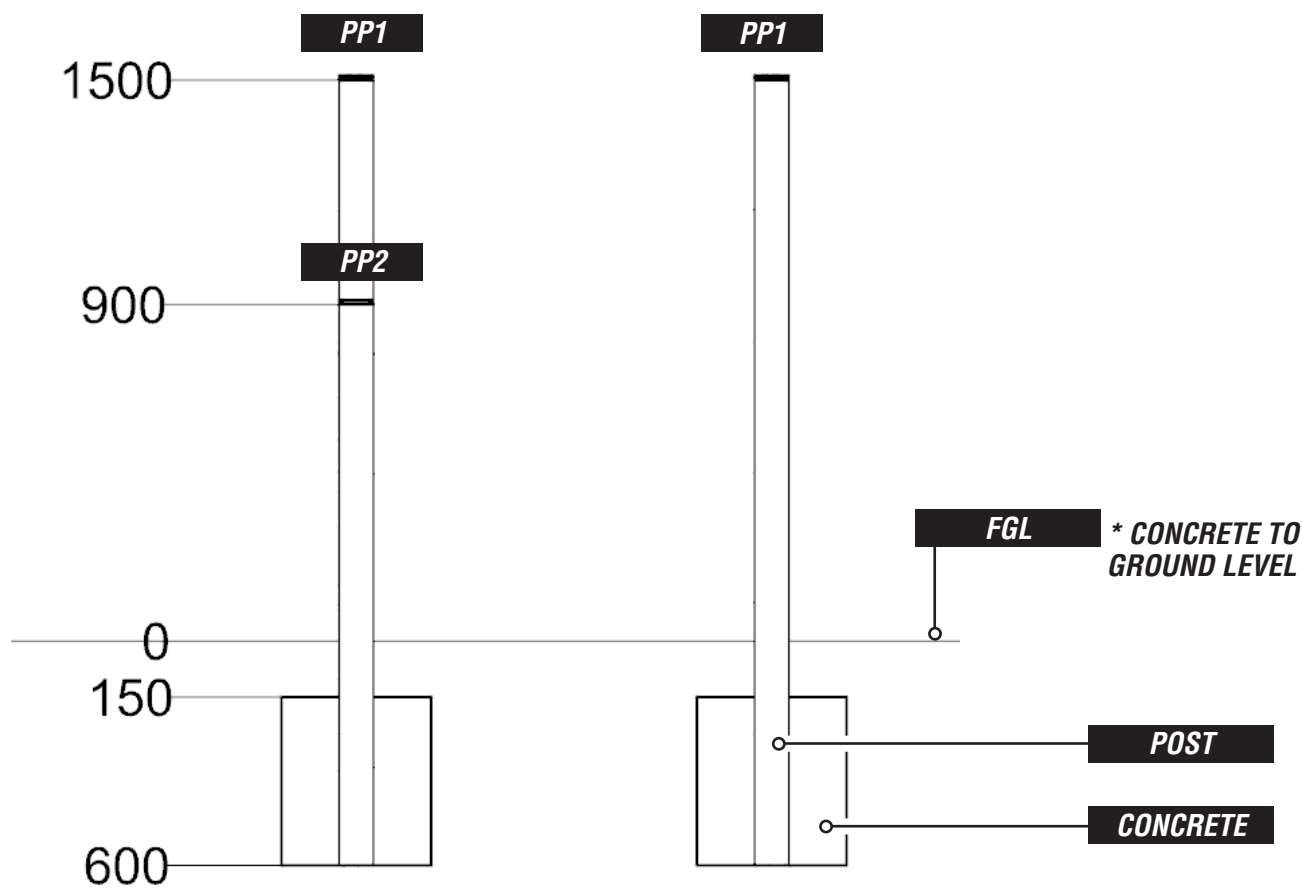
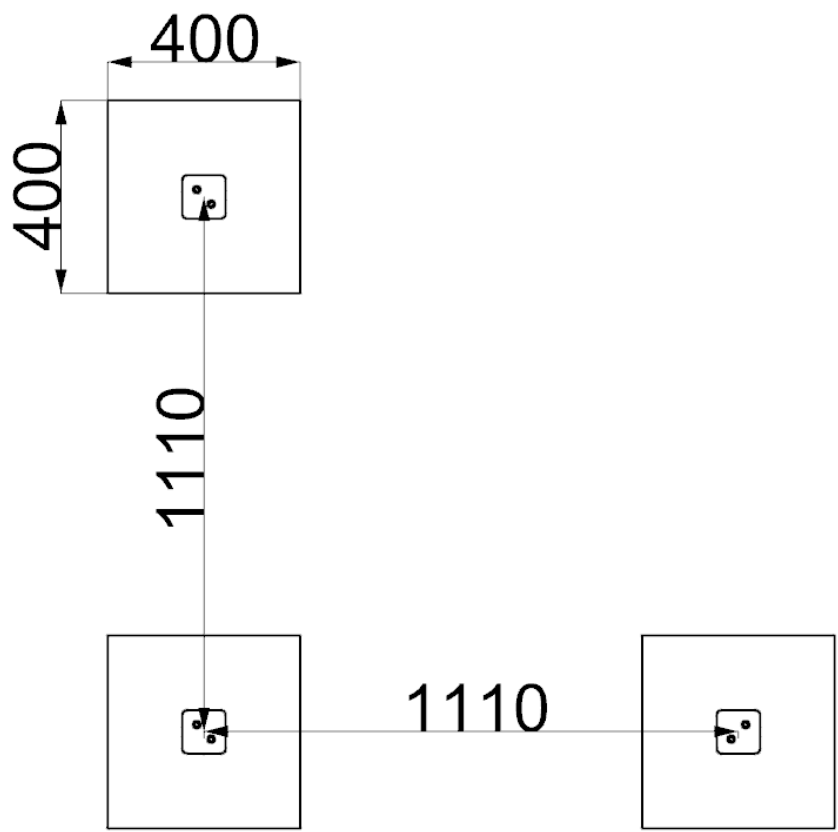

INSTALLATION INSTRUCTIONS

1

INSTALL UPRIGHT TIMBERS
ACCORDING TO GROUND PLAN

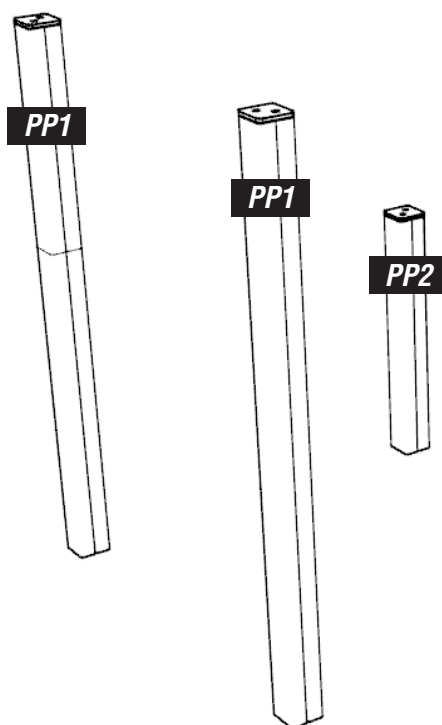

2

ATTACH LOWER PLAYTEC PANEL TO PP1 TIMBERS
USING 4X M8X80MM WOOD SCREWS

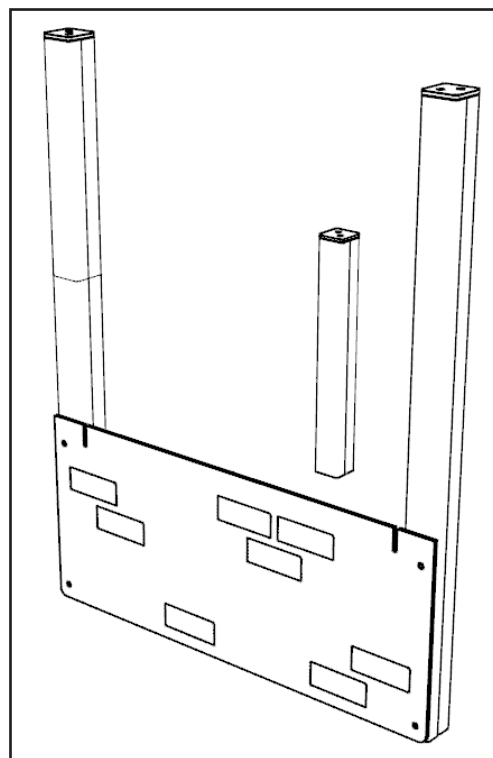
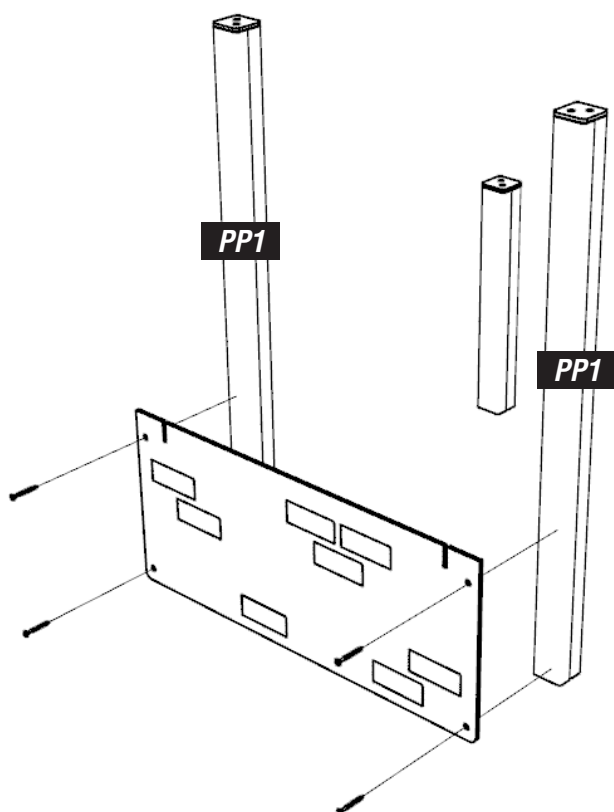

3**ATTACH SMALL BRACKETS TO LOWER PANEL**

ENSURE COUNTERSINK FACE INWARDS (SEE ARROWS), DO NOT ATTACH WITH SCRES UNTIL STEP 5

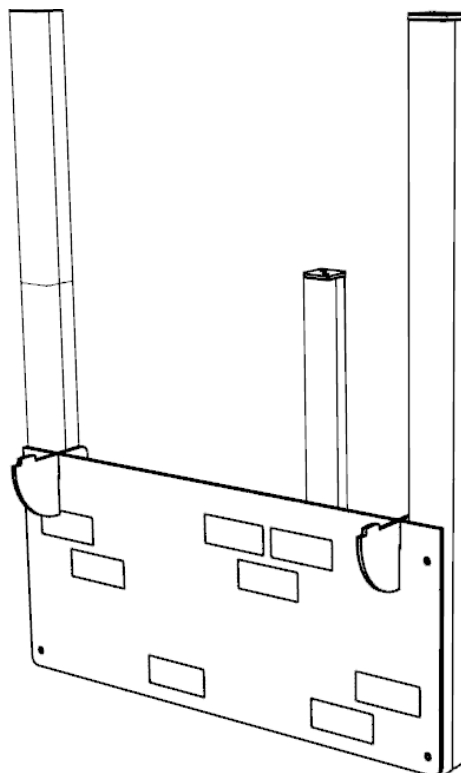
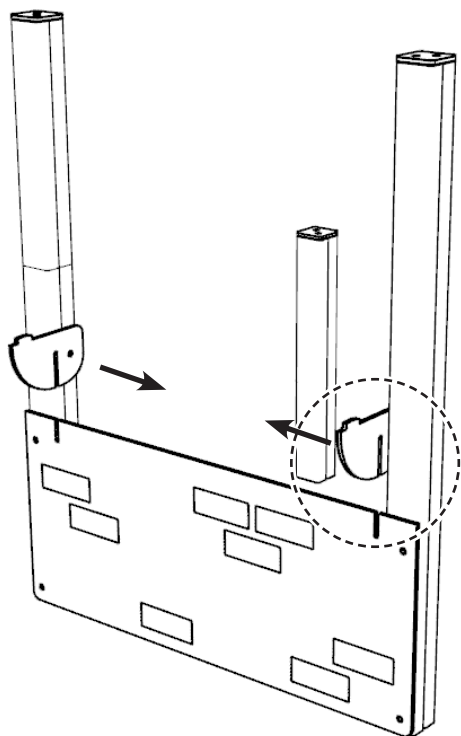
**4****ATTACH ENGRAVED PLAYTEC SHELF TO SMALL BRACKETS**

! ENSURE ENGRAVED SIDE IS FACE UPWARDS !

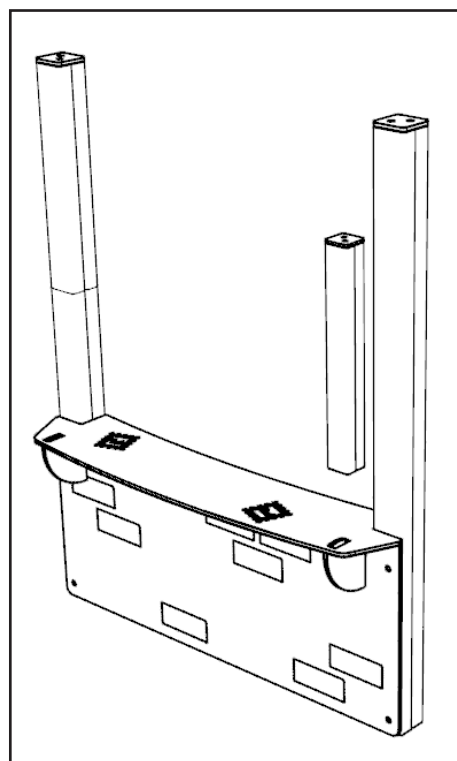
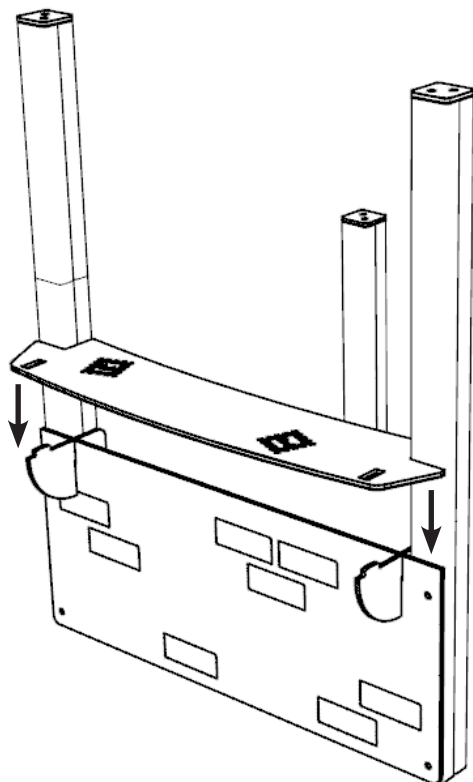

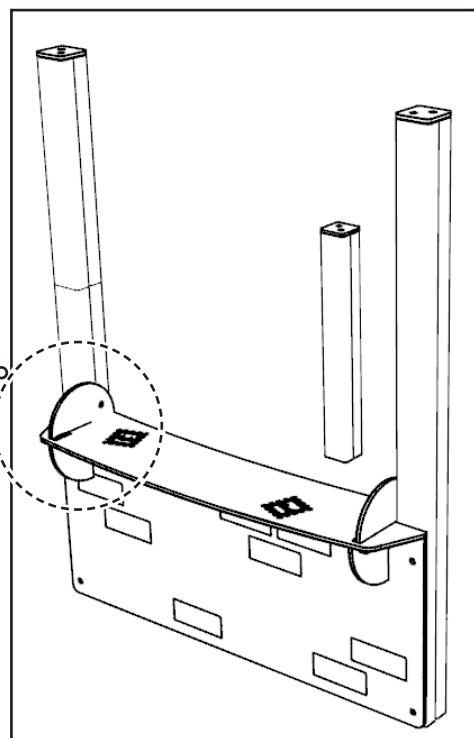
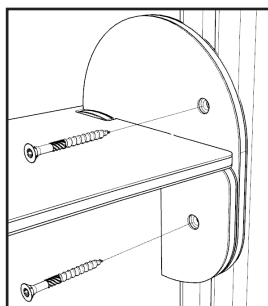
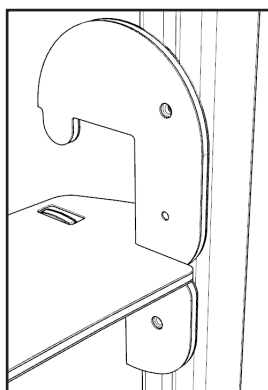
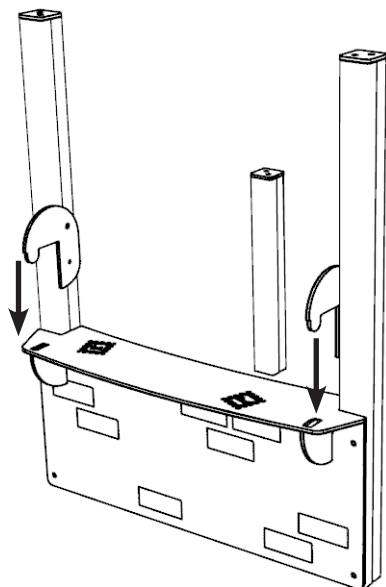
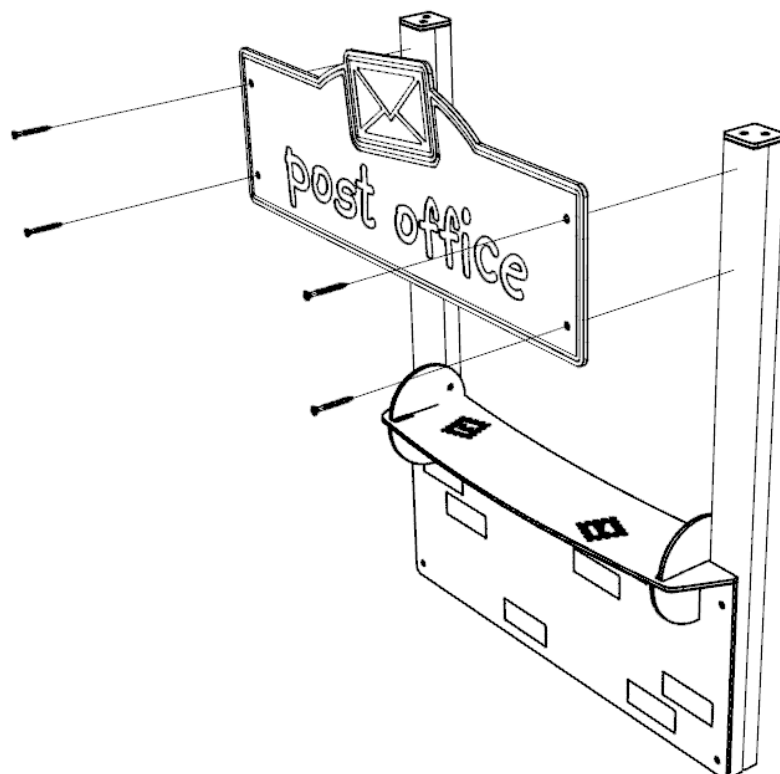
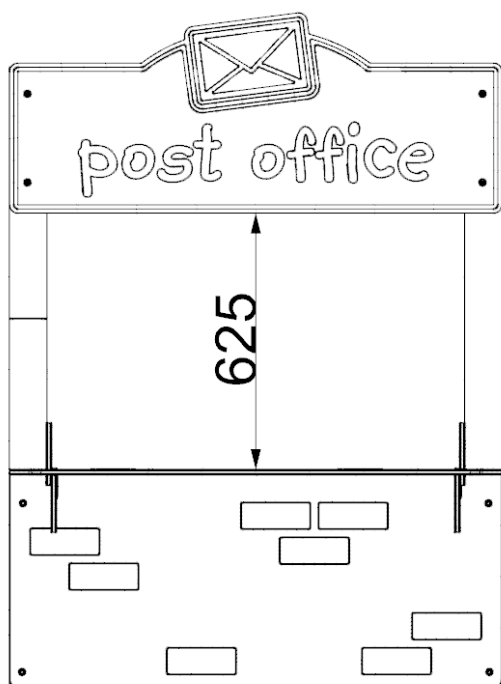
5**ATTACH LARGE BRACKETS TO PP1 TIMBERS TO SECURE SHELF IN PLACE****ENSURE COUNTERSINK FACE INWARDS (SEE ARROWS)****NOTES:****USING M8X80MM SCREWS, SECURE BRACKETS TO TIMBER UPRIGHTS - SEE RIGHT****6****ATTACH UPPER PANEL TO TOP OF PP1 UPRIGHTS****USING M8X80MM WOOD SCREWS, ENSURE IT IS POSITIONED AT DIMENSIONS SHOWN**

7

**ATTACH SIDE PANEL TO PP1 AND PP2 TIMBERS SHOWN
USING M8X80MM WOOD SCREWS**

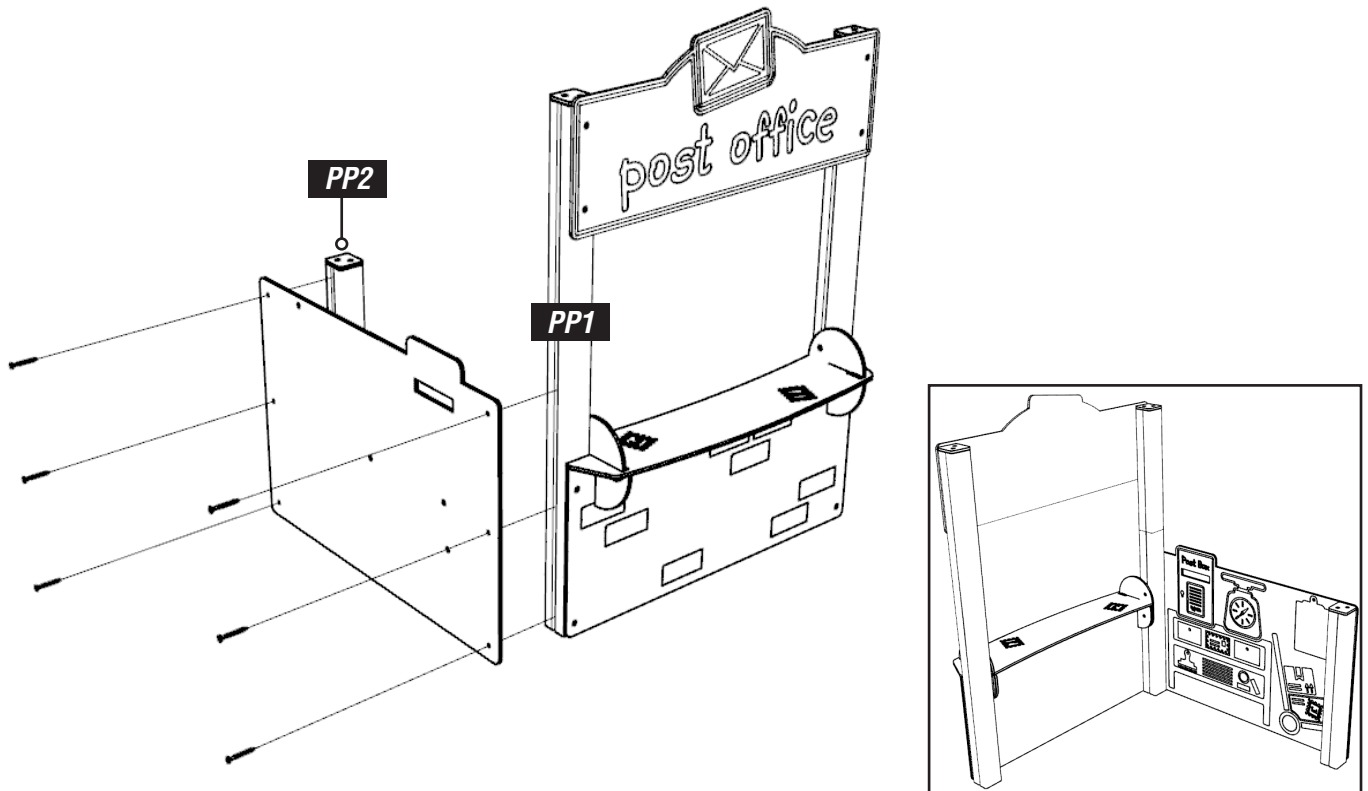
**8**

**ATTACH LOOSE PART "PEGS" TO SIDE PANEL IN LOCATIONS SHOWN
USING M10X60MM SOCKET BUTTON BOLT WTH SLEEVE / M10 NUT / 102003-01**

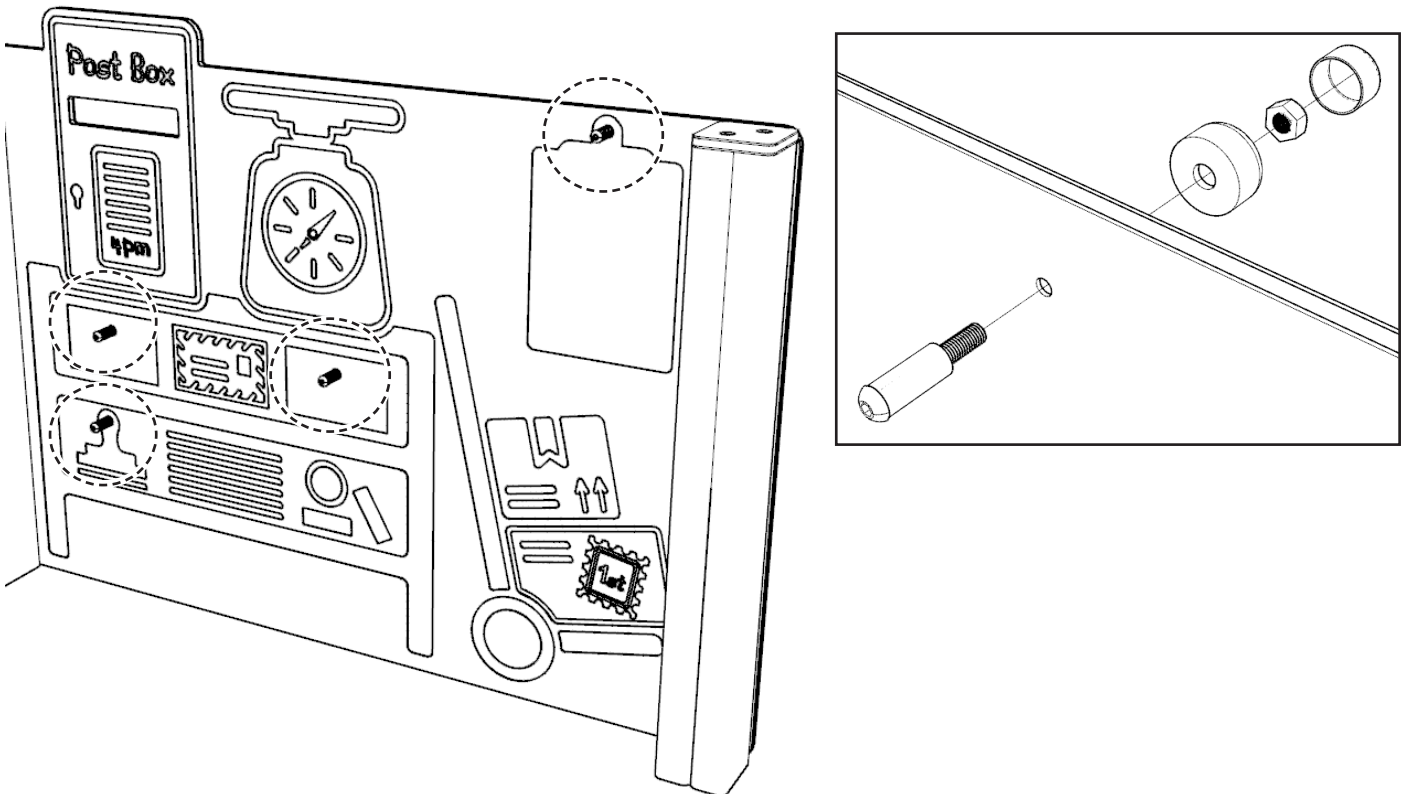

9

HOOK LOOSE PARTS TO PEGS IN CORRECT LOCATIONS

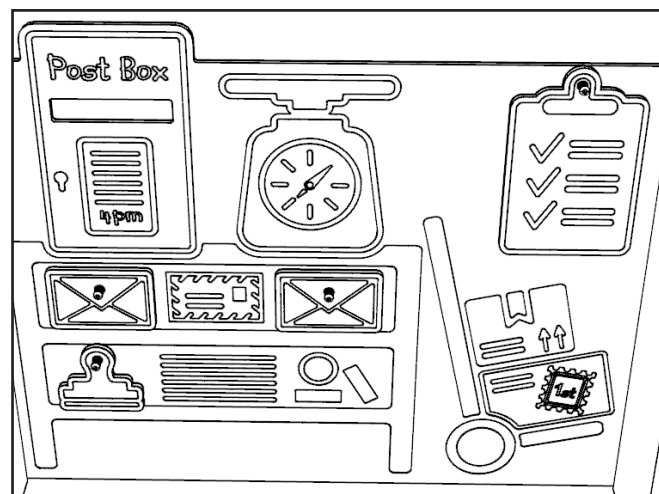

ADDITIONAL DIMENSIONS

