

CH150 - A FRAME TUNNEL

Installation Instructions

**creative
play**

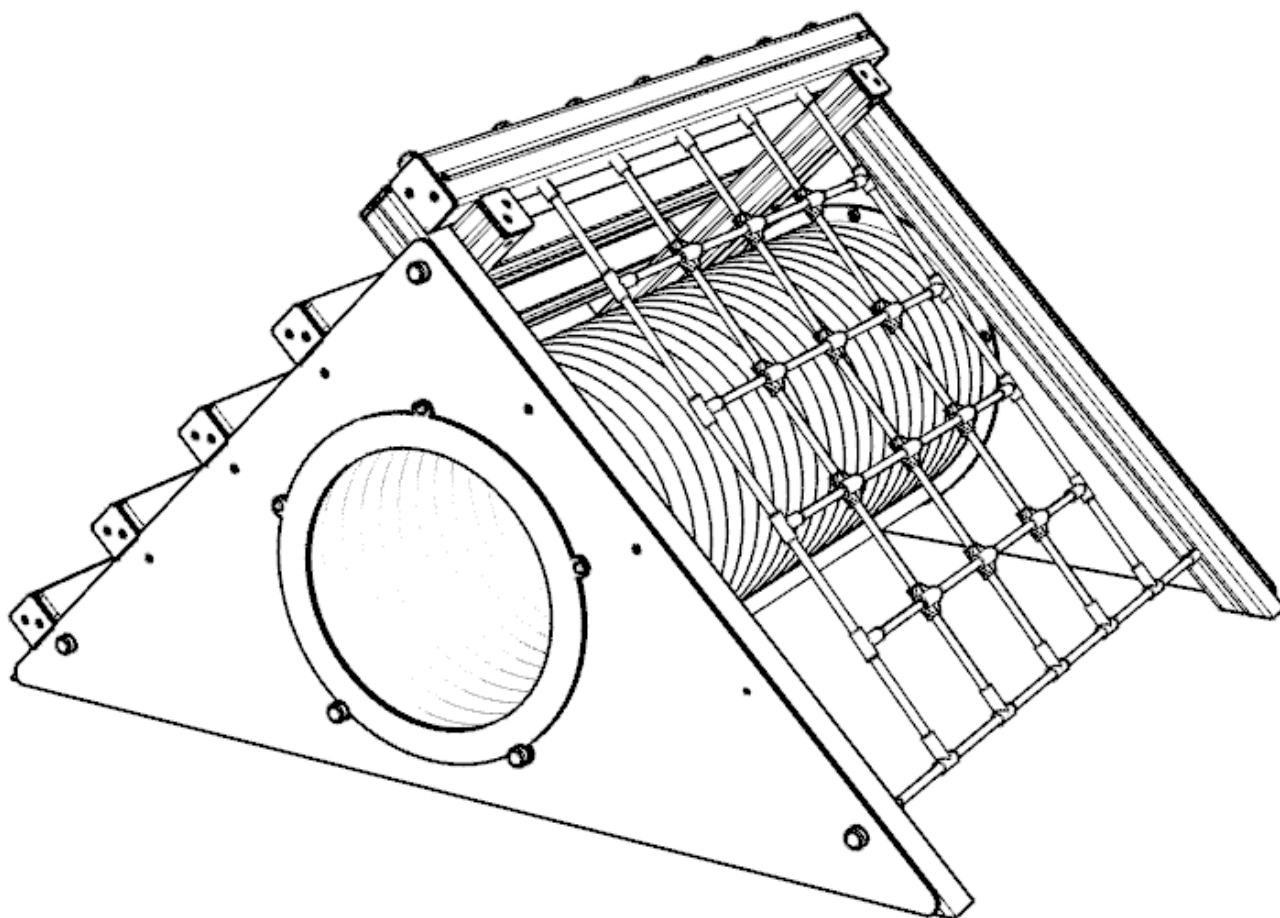
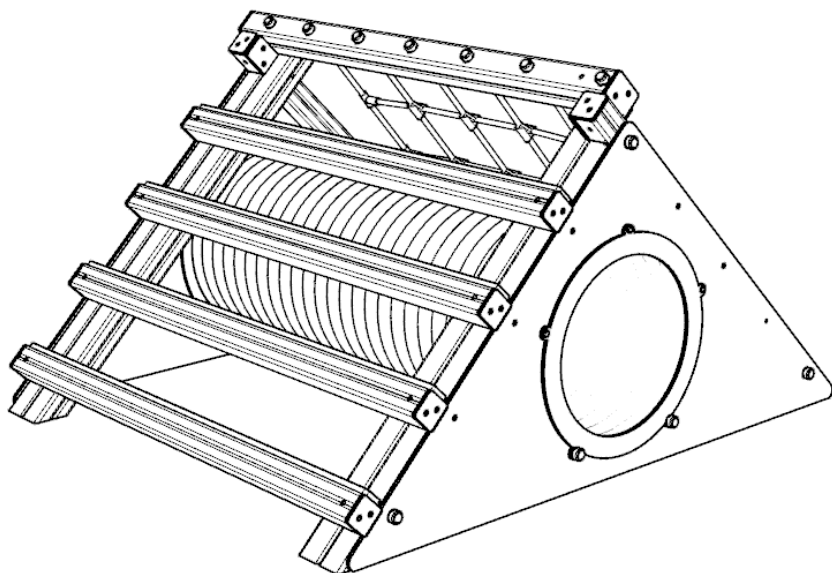

PARTS REQUIRED

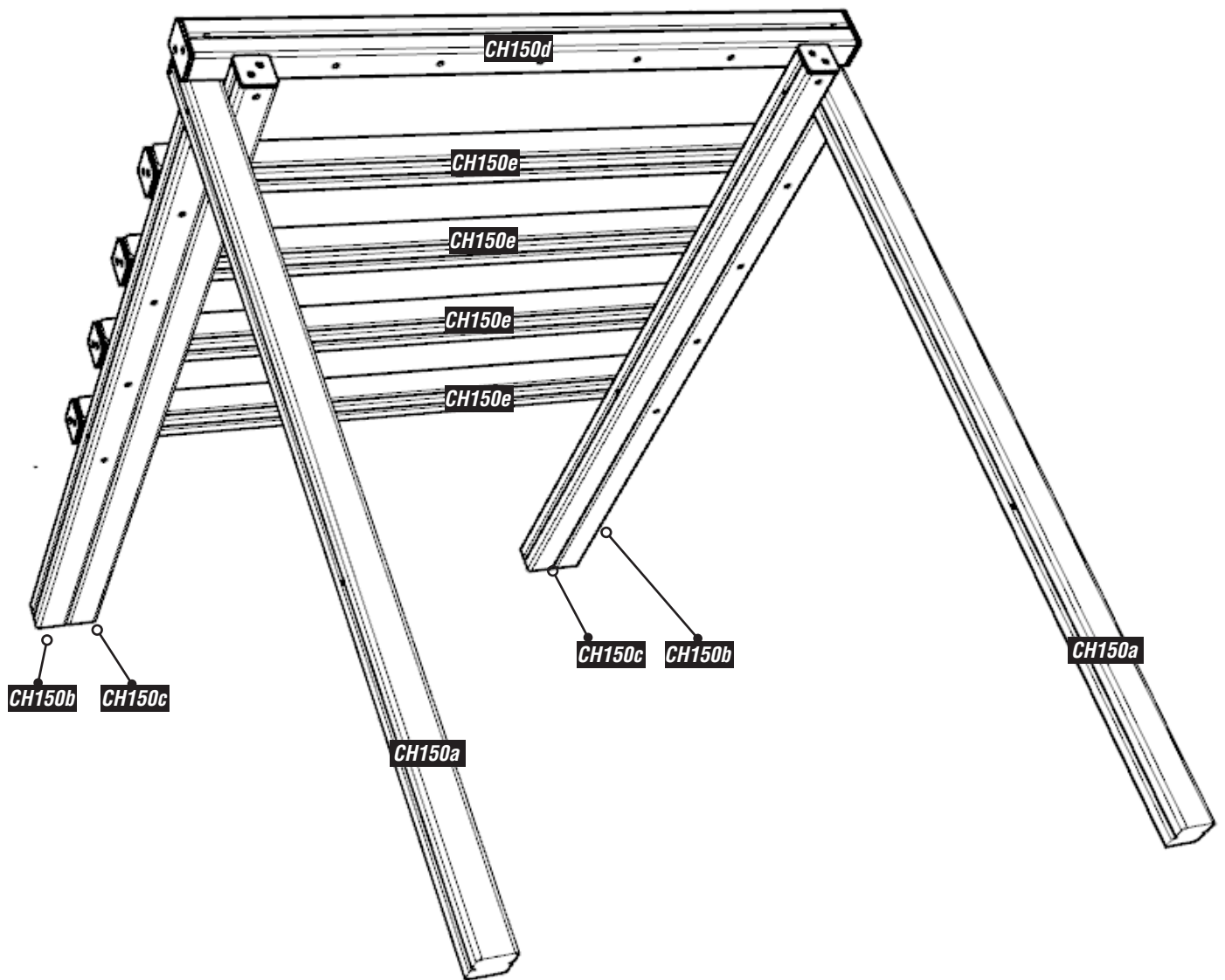

TIMBERS

CH150 - A FRAME TUNNEL

Installation Instructions

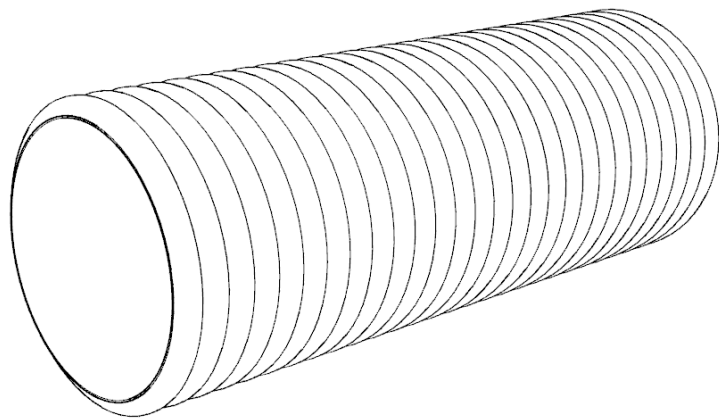

x1

600MM DIA TWINWALL TUBING (1820MM LENGTH)

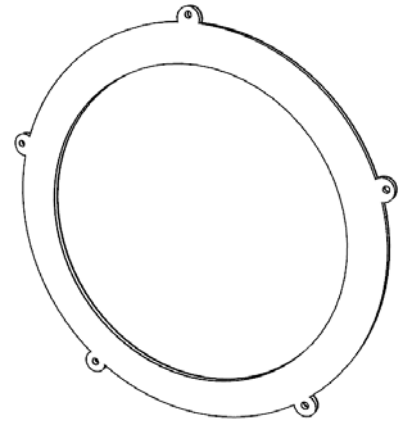

x2

OUTER TUNNEL WASHER

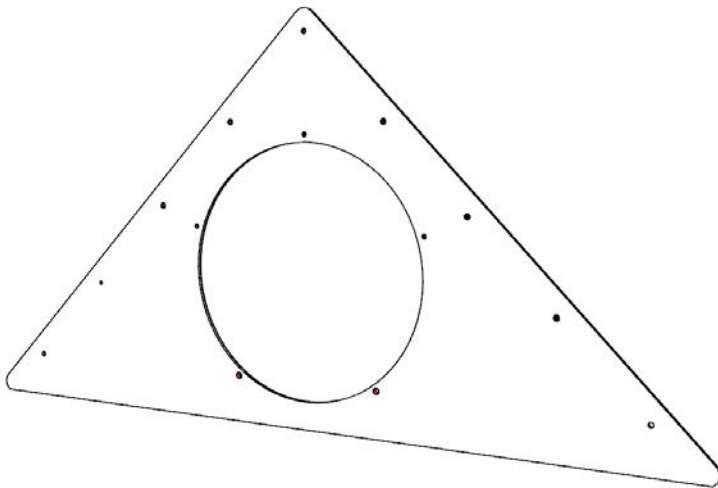

x2

TRIANGLE PANEL

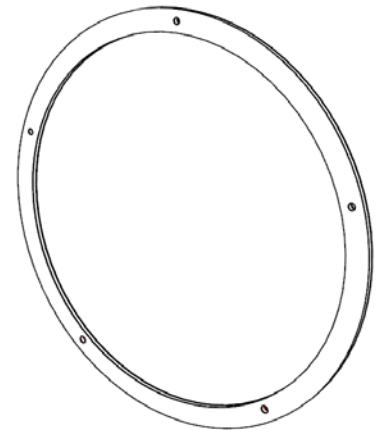

x2

INNER TUNNEL WASHER

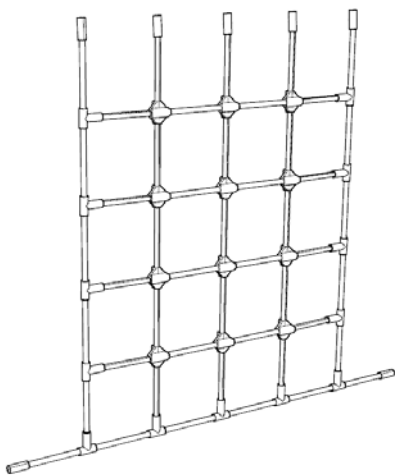

x1

CARGO NET

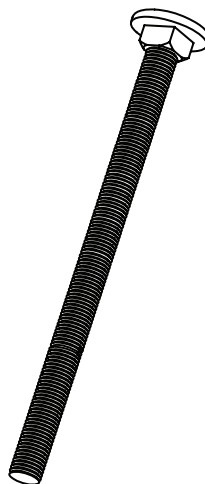

x6

274. M12X220

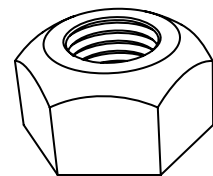

x29

656. M12

CH150 - A FRAME TUNNEL

Installation Instructions

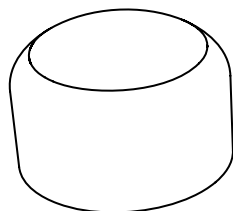

x29

102003-01 - M12

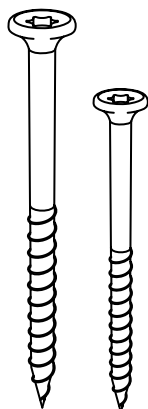

x8

97.M8X180CSK

x16

97.M8X80CSK

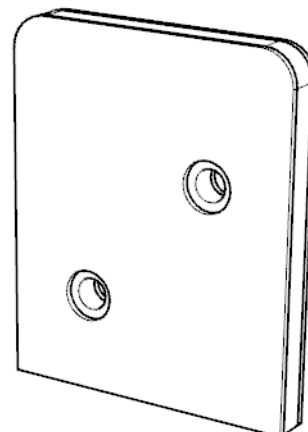

x2

CUT 90X120 END CAP

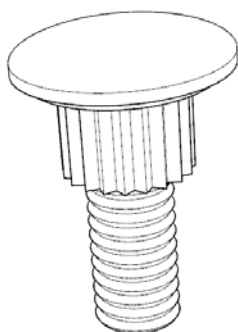

x6

TORKTAINER BOLT - 4B

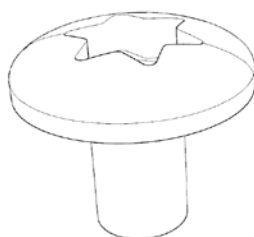

x6

TORKTAINER NUT - N3

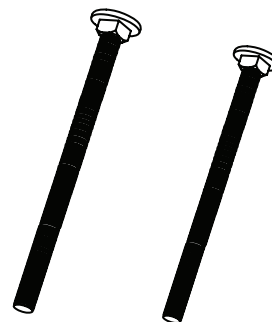

x2

274.M12X230

x10

274.M12X200

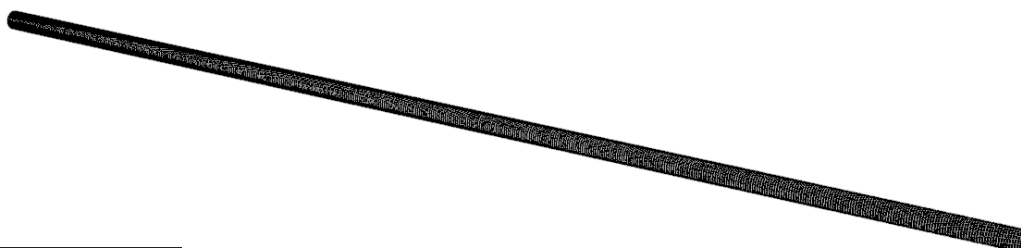

x2

THREADED BAR (1872MM)

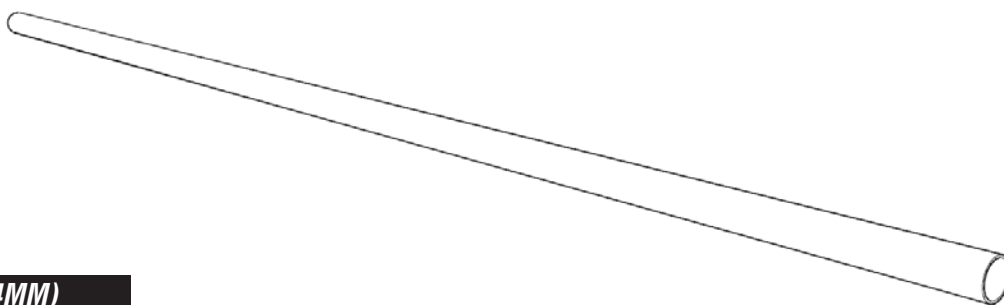

x2

GALV BAR (1784MM)

FOUNDATION DETAILS

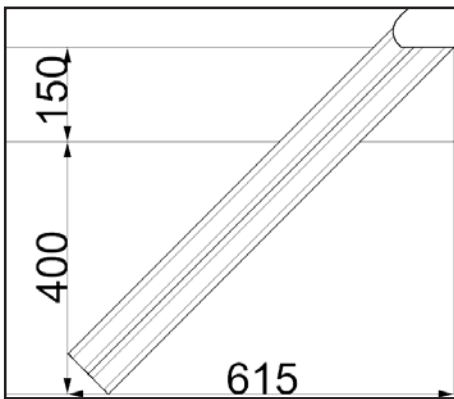
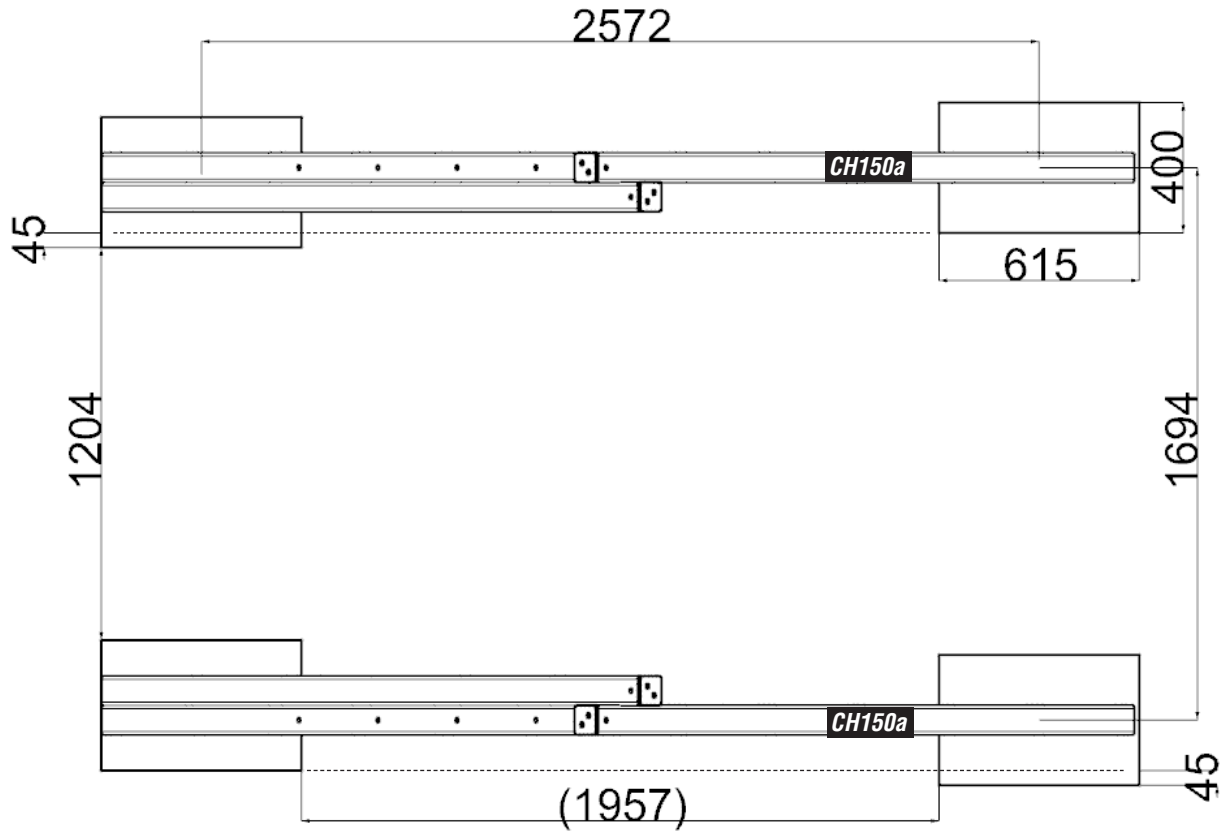

NOTES:
 FOUNDATIONS ARE OFFSET BY 45MM
 AS SHOWN ABOVE TO ENSURE THEY
 ARE CENTERED TO POSTS

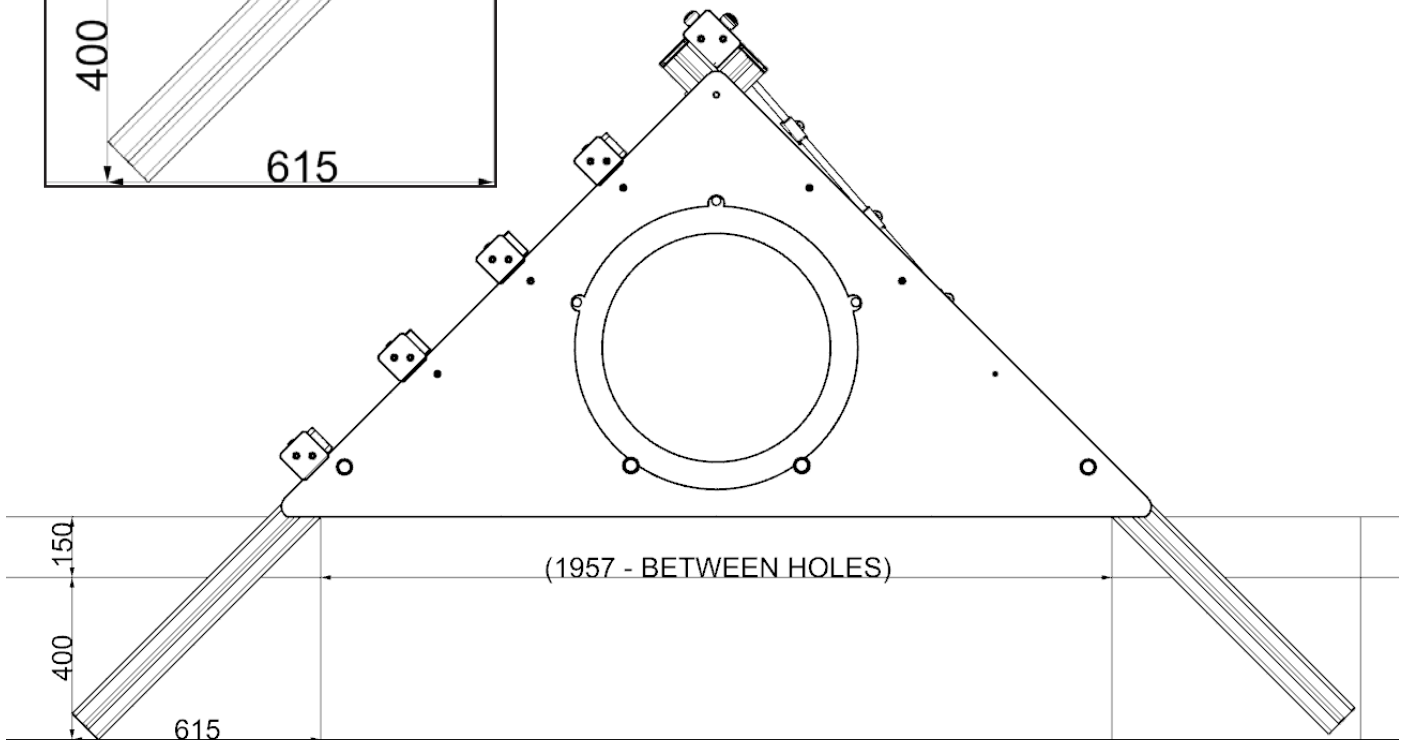

SURFACING DETAILS

- - - = MINIMUM SPACE
- = SURFACE AREA

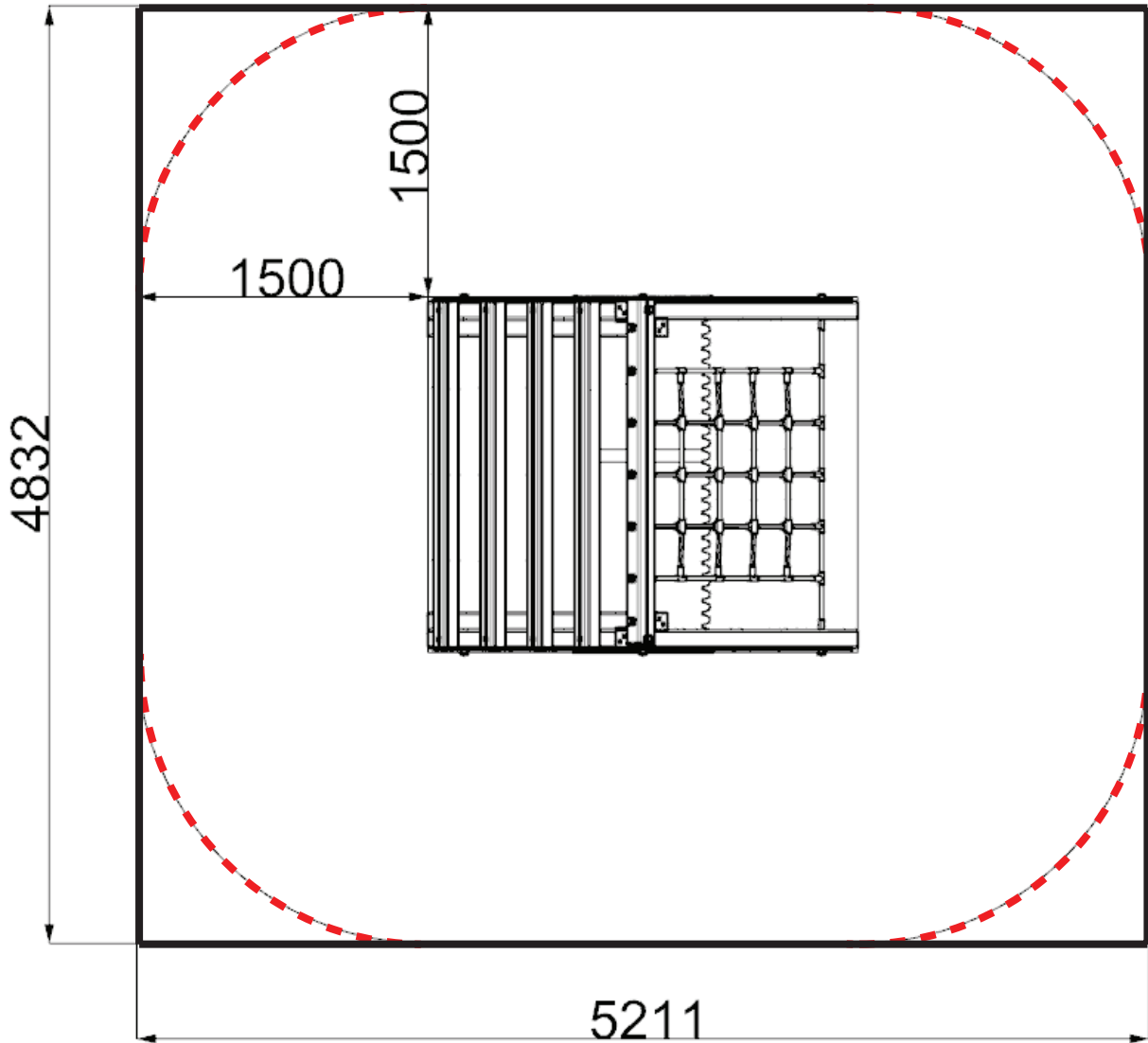

INSTALLATION INSTRUCTIONS

1 ATTACH CH150a/b/c TIMBERS TO A PLAYTEC TRIANGLE USING 274.M12X220 / 656.M12 / 102003-01 - M12 / M8X180MM WOOD SCREWS

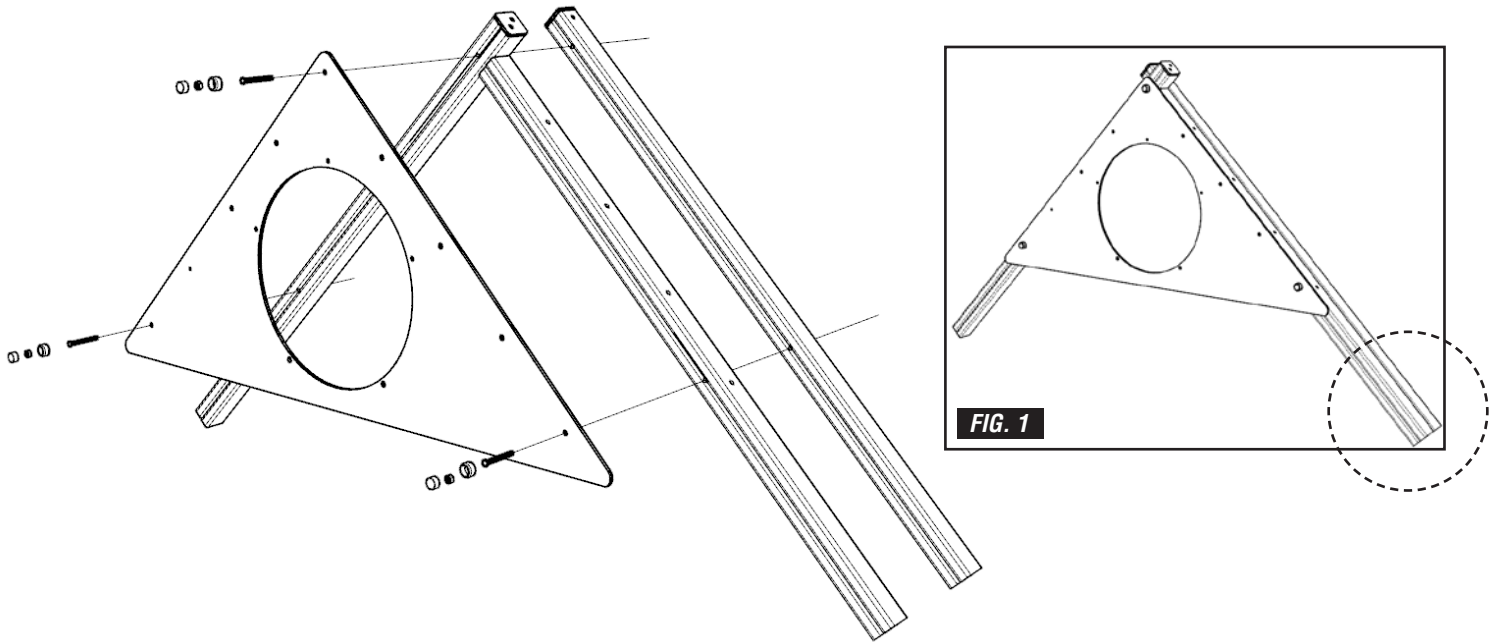

NOTES:

CONSTRUCT MAIN ASSEMBLY BEFORE LAYING CONCRETE FOUNDATIONS - STEP 6
SCREW BOTTOM OF CH150b & CH150c TIMBERS TOGETHER USING 180 WOOD SCREWS (SEE FIG. 1)

2 POSITON TWINWALL TUBE TO PLAYTEC TRIANGLE WITH OUTER & INNER WASHERS USING 3 TORKTAINERS 4B/N3 IN HOLES SHOWN BELOW

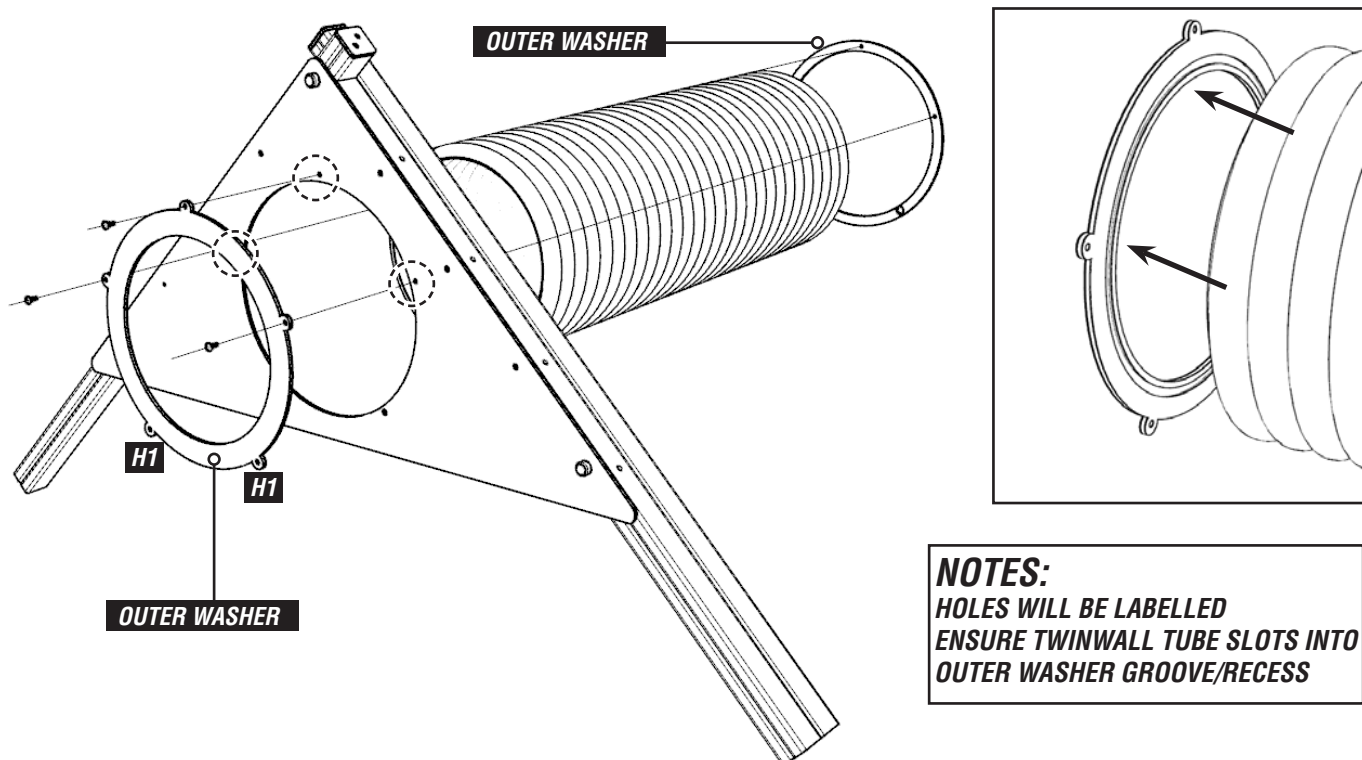

NOTES:

HOLES WILL BE LABELLED
ENSURE TWINWALL TUBE SLOTS INTO
OUTER WASHER GROOVE/RECESS

INSTALLATION INSTRUCTIONS

3 SECURE GALV BARS & THREAD BAR TO PLAYTEC TRIANGLE TO HOLES SHOWN
USING - 656.M12 / 102003-01-M12

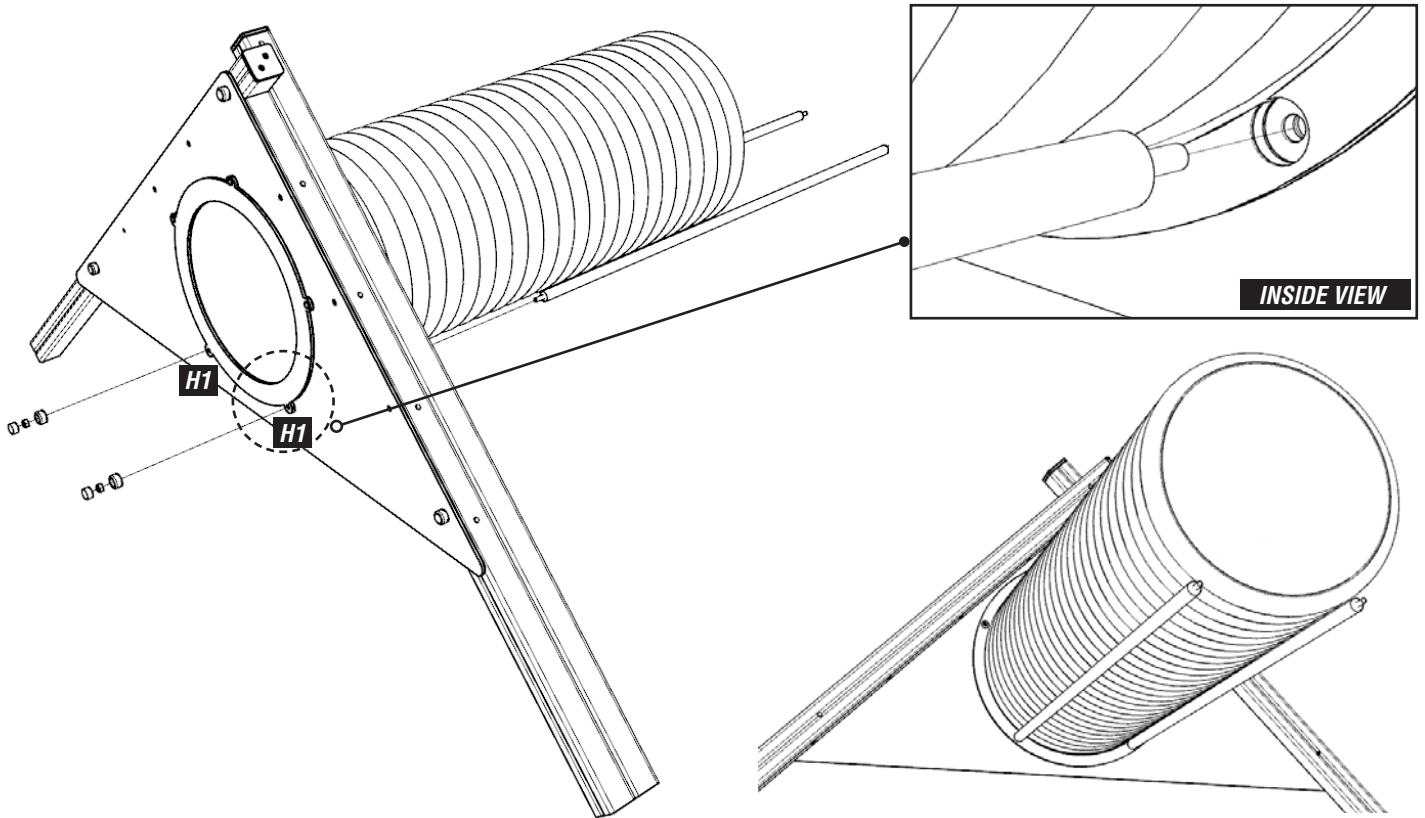

4 REPEAT STEPS 1-3 FOR THE OPPOSITE SIDE
USING TORKTAINERS, 274.M12X220 / 656.M12 / 102003-01-M12 / M8X180MM WOOD SCREWS

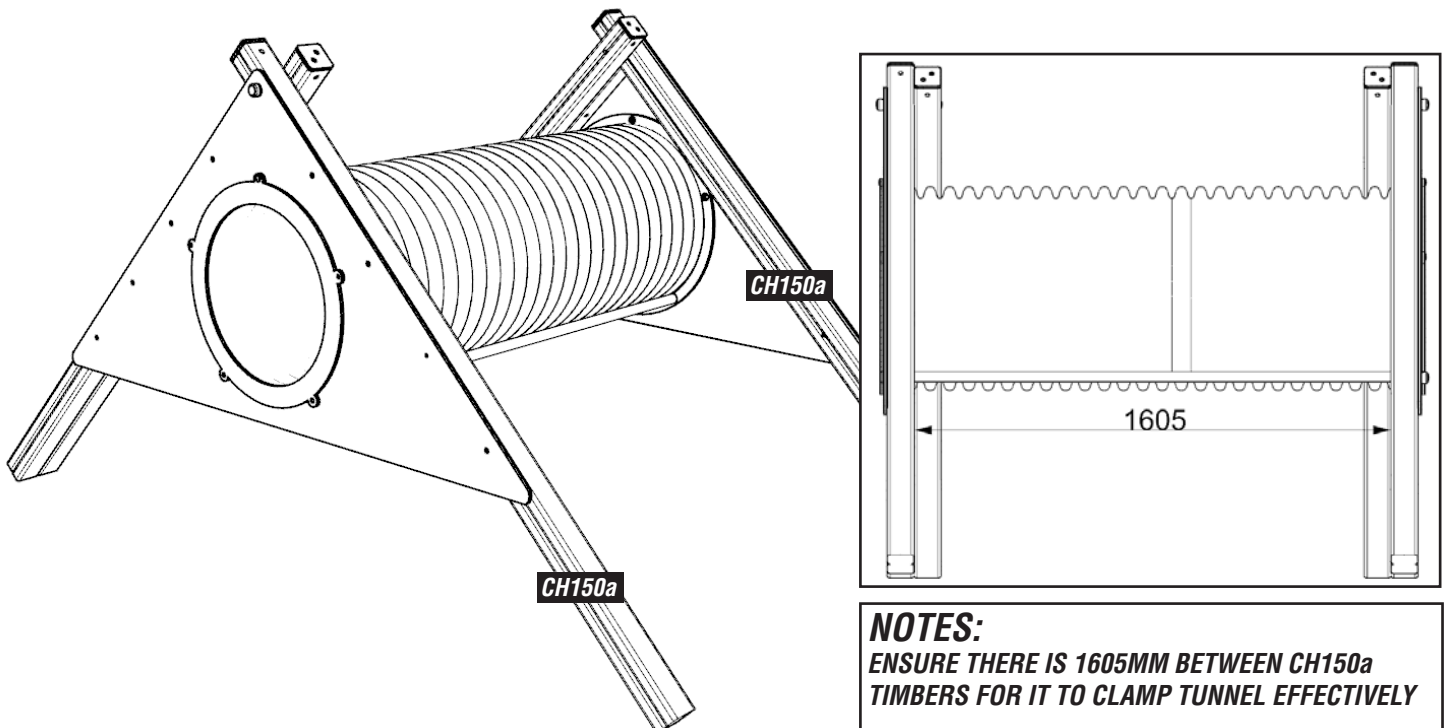

INSTALLATION INSTRUCTIONS

5

FURTHER FASTEN PLAYTEC TRIANGLE TO TIMBERS

USING 12X M8X80MM WOOD SCREWS (6 PER SIDE) IN HOLES SHOWN BELOW

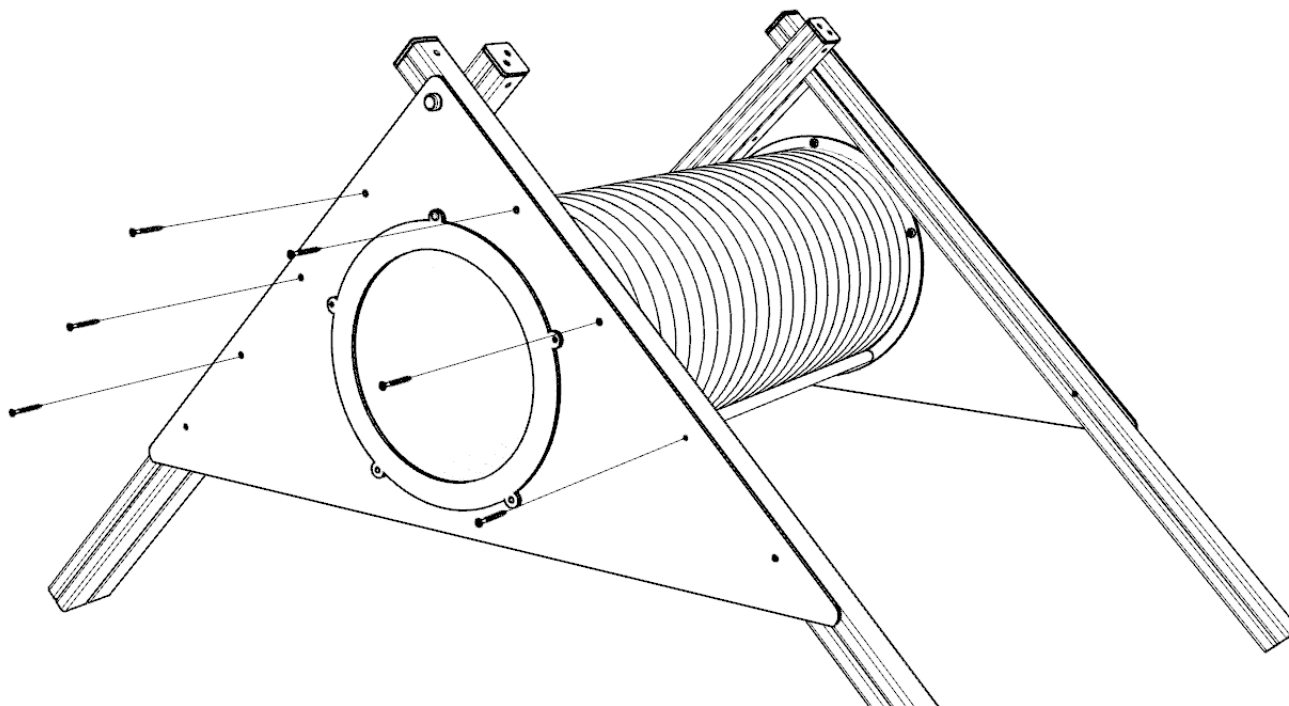

6

ATTACH CH150d TIMBER TO A FRAME AS SHOWN

USING 274.M12X200 / 274.M12X230 / 656.M12 / 102003-01-M12

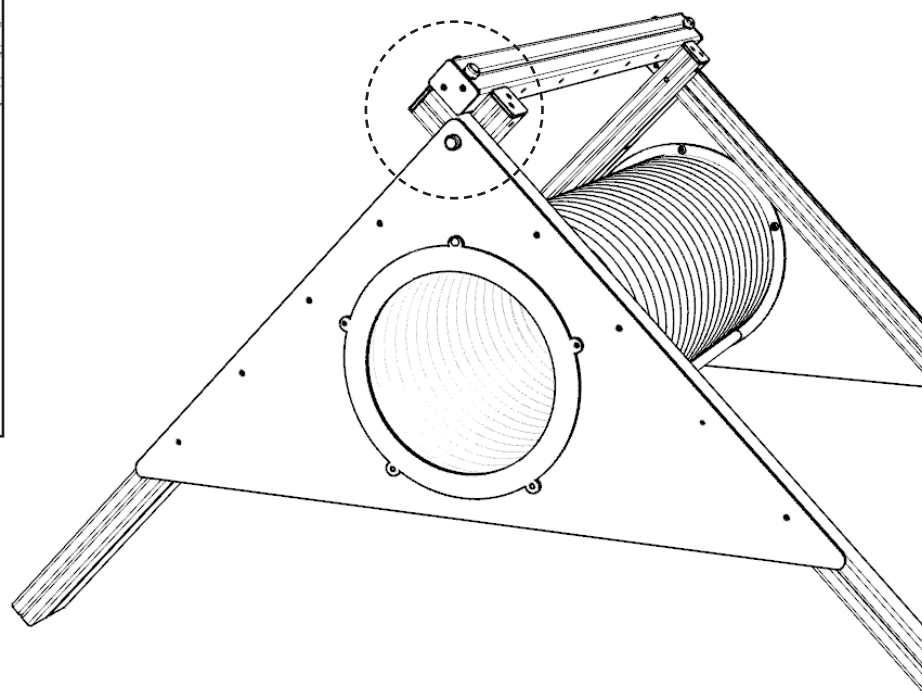
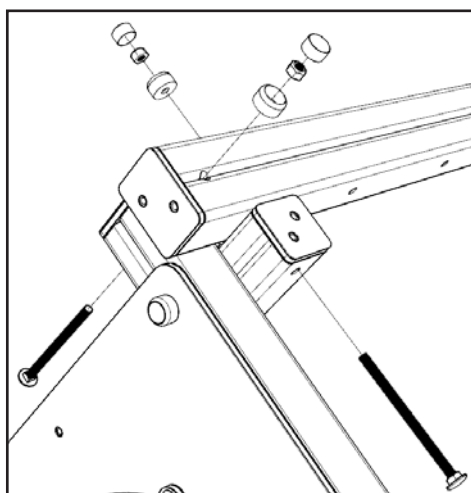

INSTALLATION INSTRUCTIONS

7 ATTACH CARGO NET TO CH150d TIMBER USING 656.M12 / 102003-01

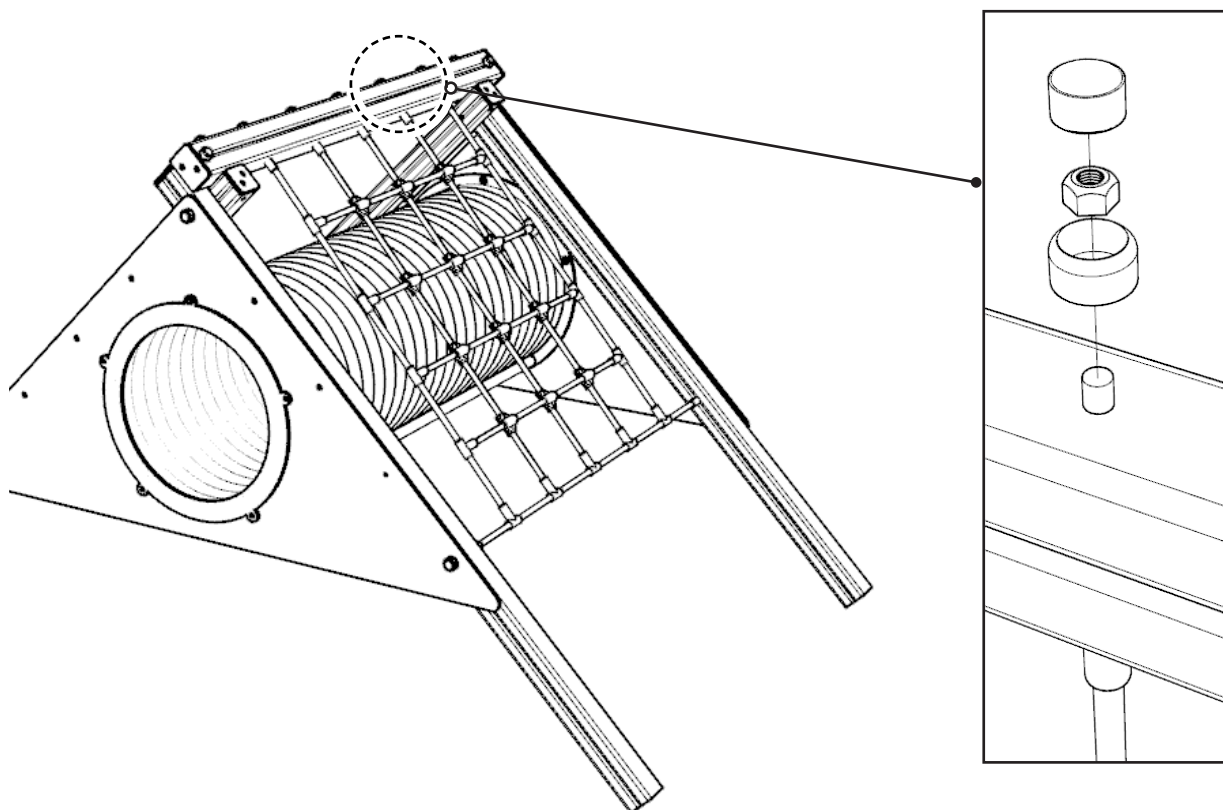

8 ATTACH CUT END CAPS TO FACES OF CH150a TIMBERS SHOWN BELOW USING M8X80MM WOOD SCREWS, ENSURE CUT EDGE IS FLUSH TO ANGLED A FRAME TIMBERS

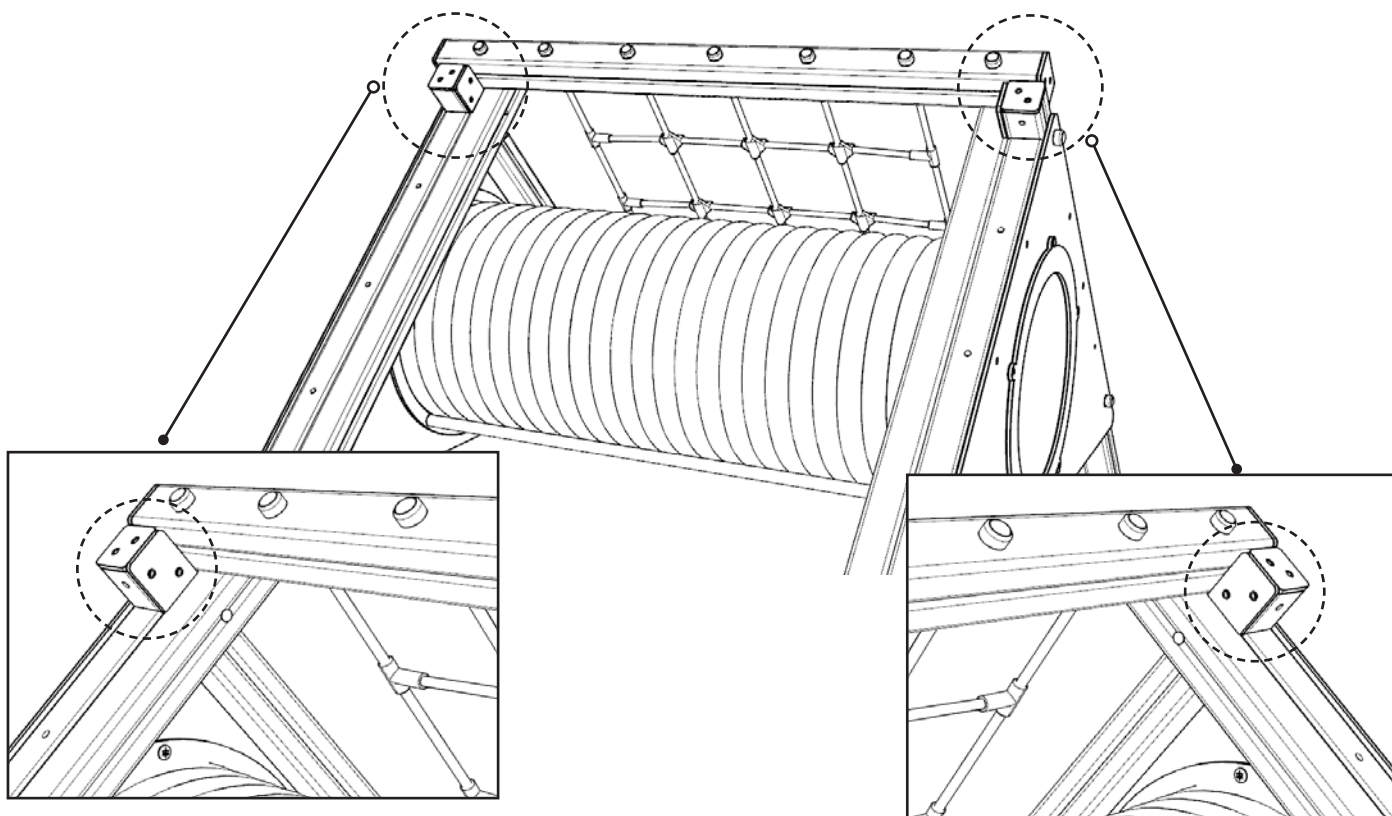

INSTALLATION INSTRUCTIONS

9

ATTACH CH150e TIMBERS TO A FRAME HOLES SHOWN

USING 274.M12X200 / 656.M12 / 102003-01-M12

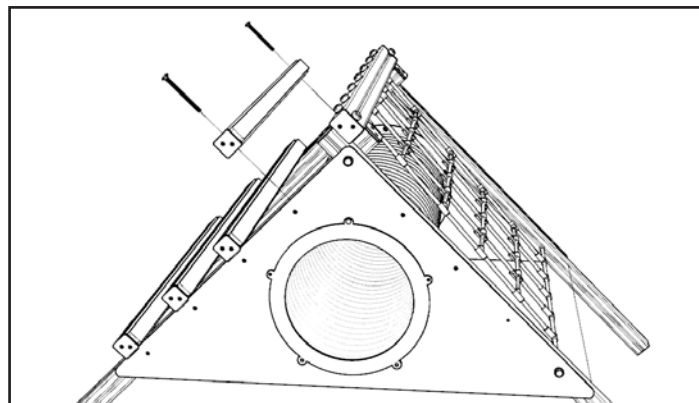
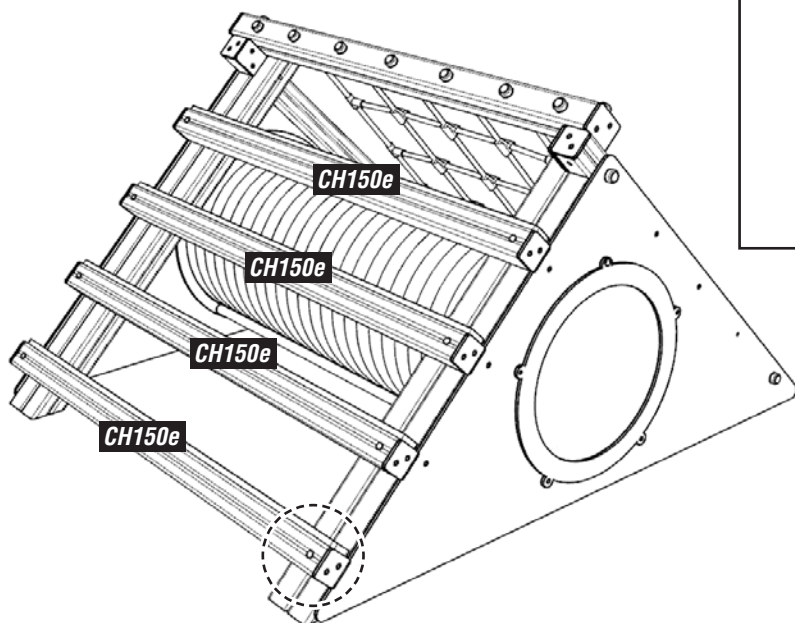

NOTES:

ENSURE END CAPS ARE PLACED ON UNDERSIDE OF TIMBER, BOLT HEADS VISIBLE AS SHOWN TO LEFT

CH150e TIMBERS ARE PRE-ASSEMBLED WITH HEXBOARD SLATS

ADDITIONAL DIMENSIONS

