

CH145 - INCLINED NET

Installation Instructions

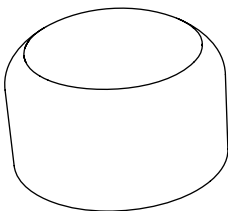
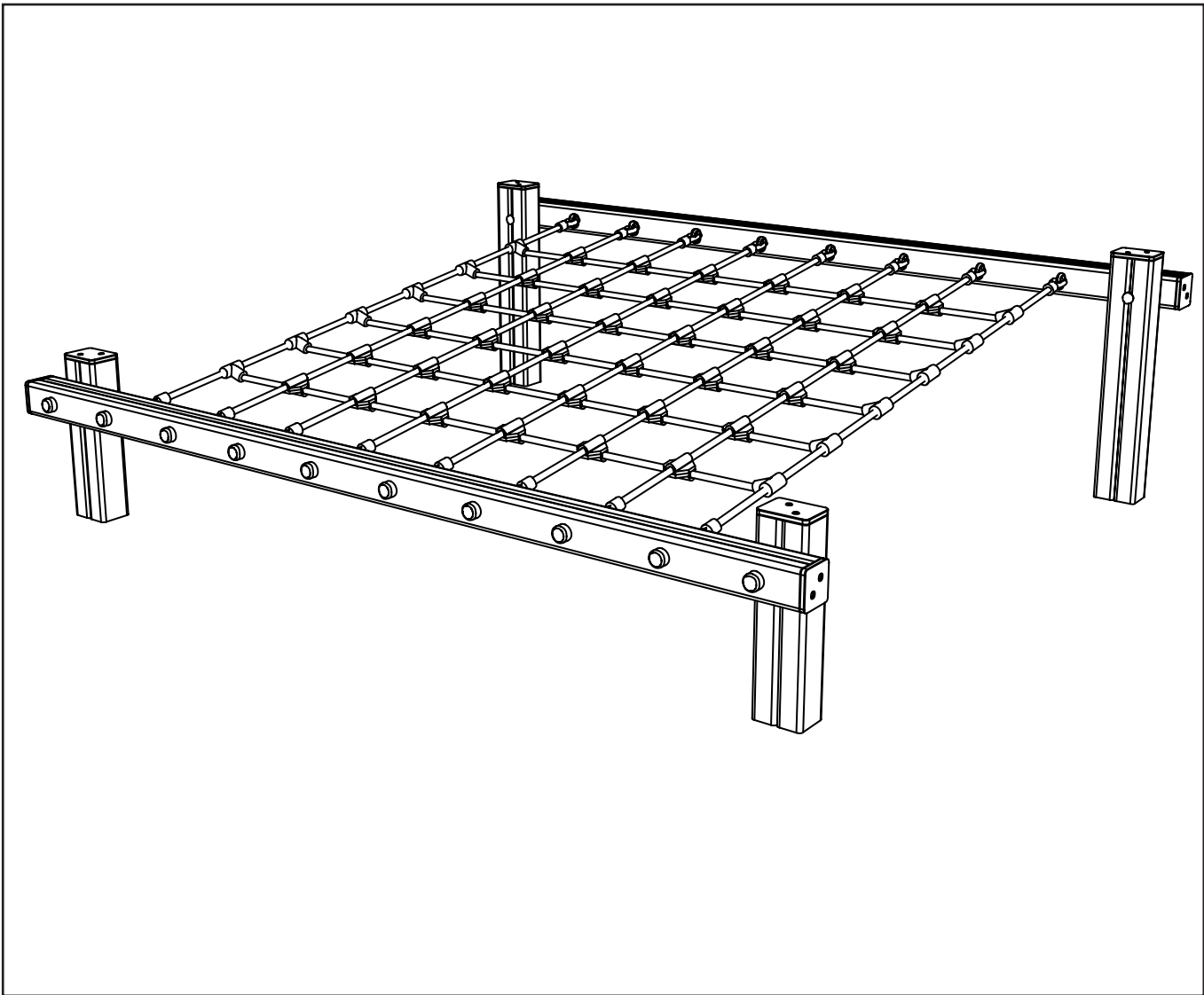

x20

102003-01

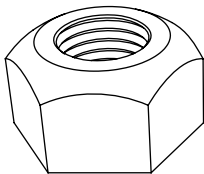

x4

656.M12

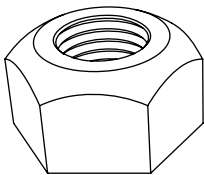

x16

656.M10

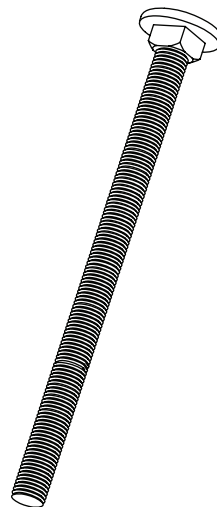

x4

274.M12X200

PARTS REQUIRED CONTINUED...



x2

CH145-B

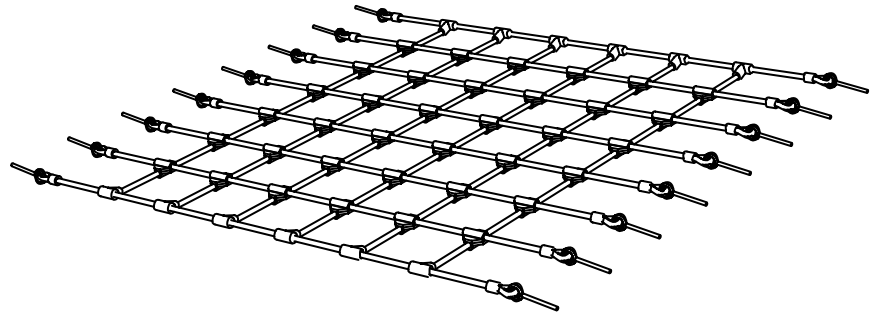

x1

NET ASSEMBLY



x2

CH145-C

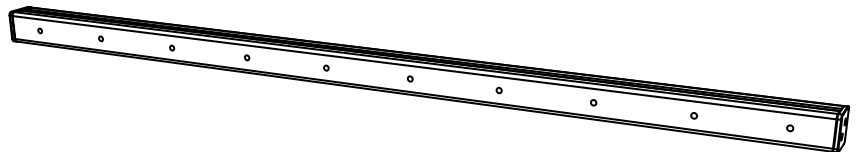

x2

CH145-A

FOUNDATIONS

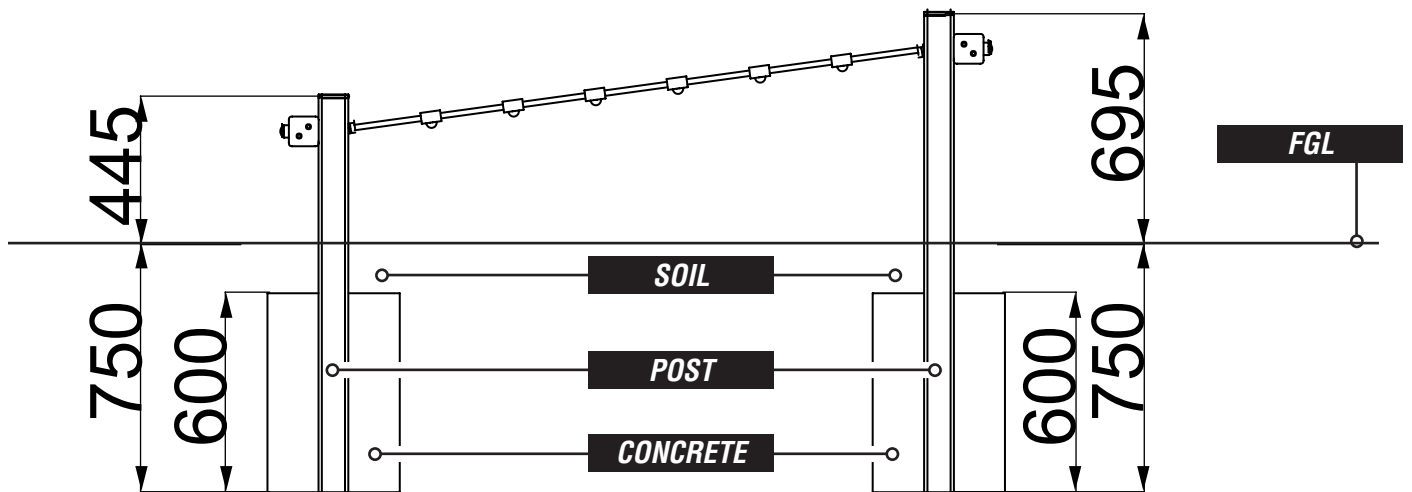
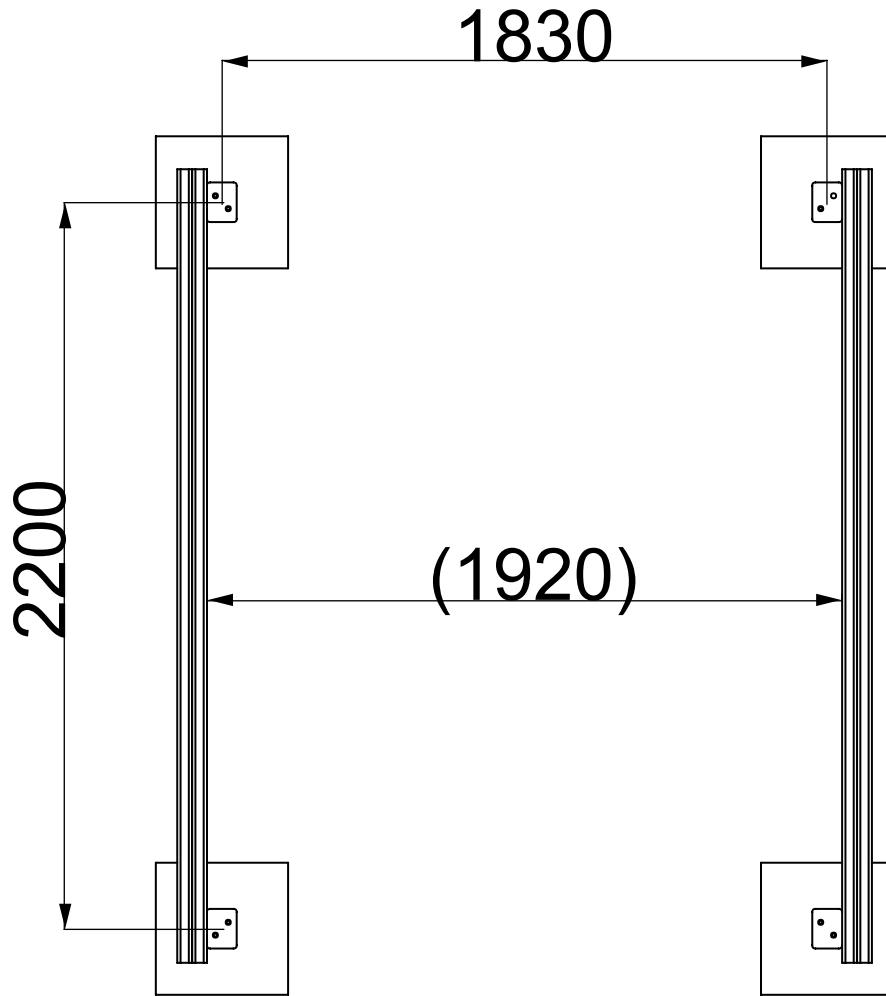

SURFACING

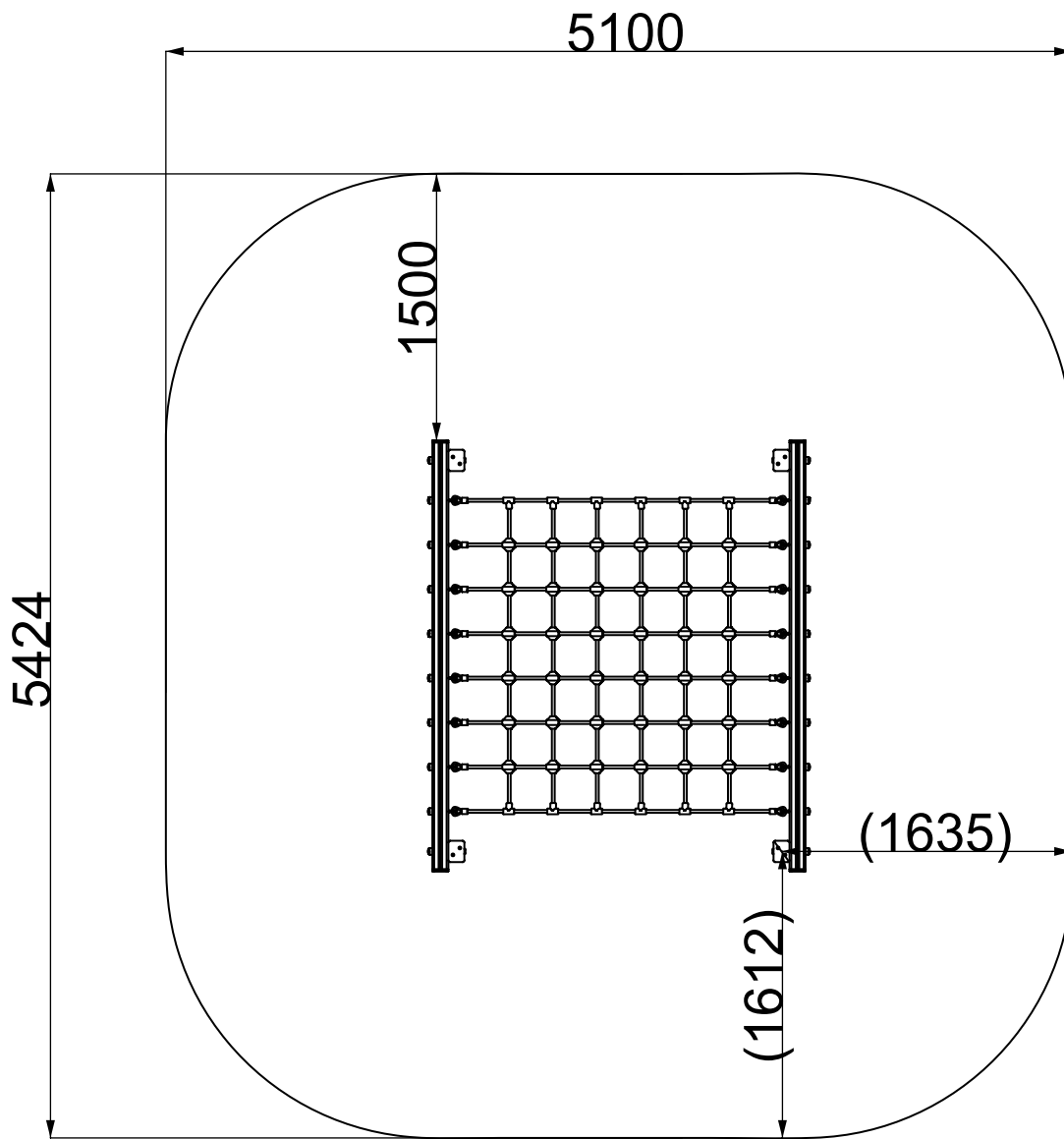

INSTALLATION INSTRUCTIONS

1

BOLT A TIMBERS TO B / C TIMBERS

USING - 274.M12X200 / 656.M12 / 102003-01

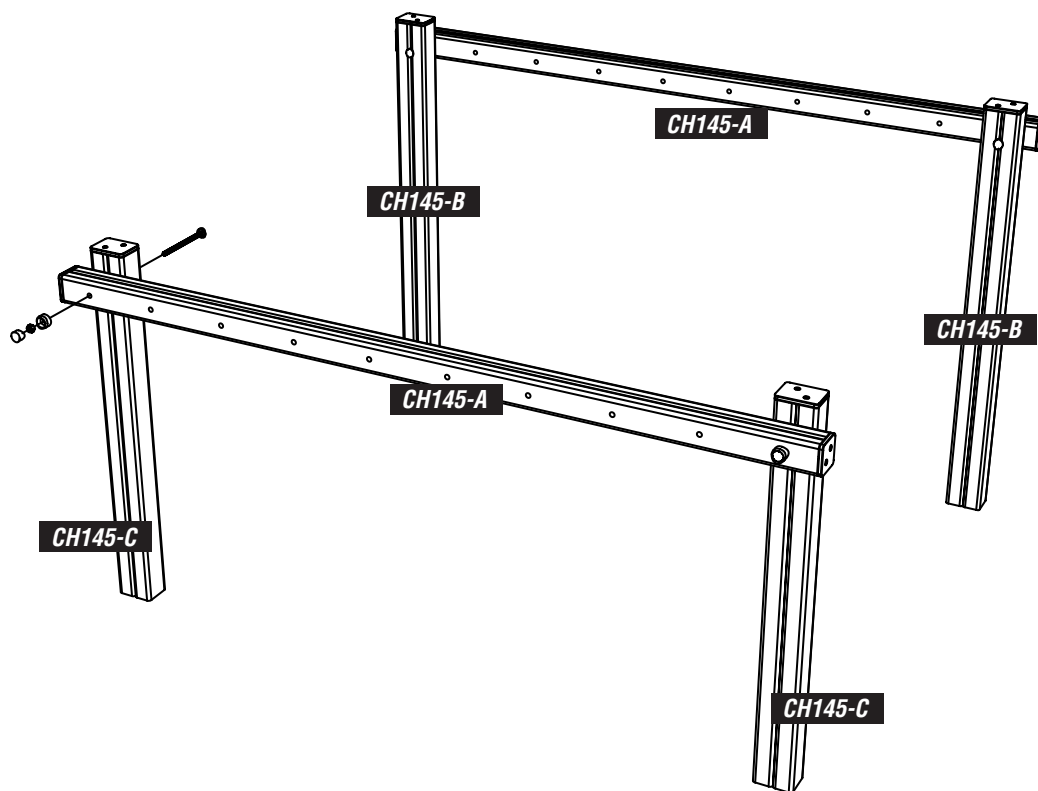

2

ATTACH THE NET ASSEMBLY

USING - 656.M10

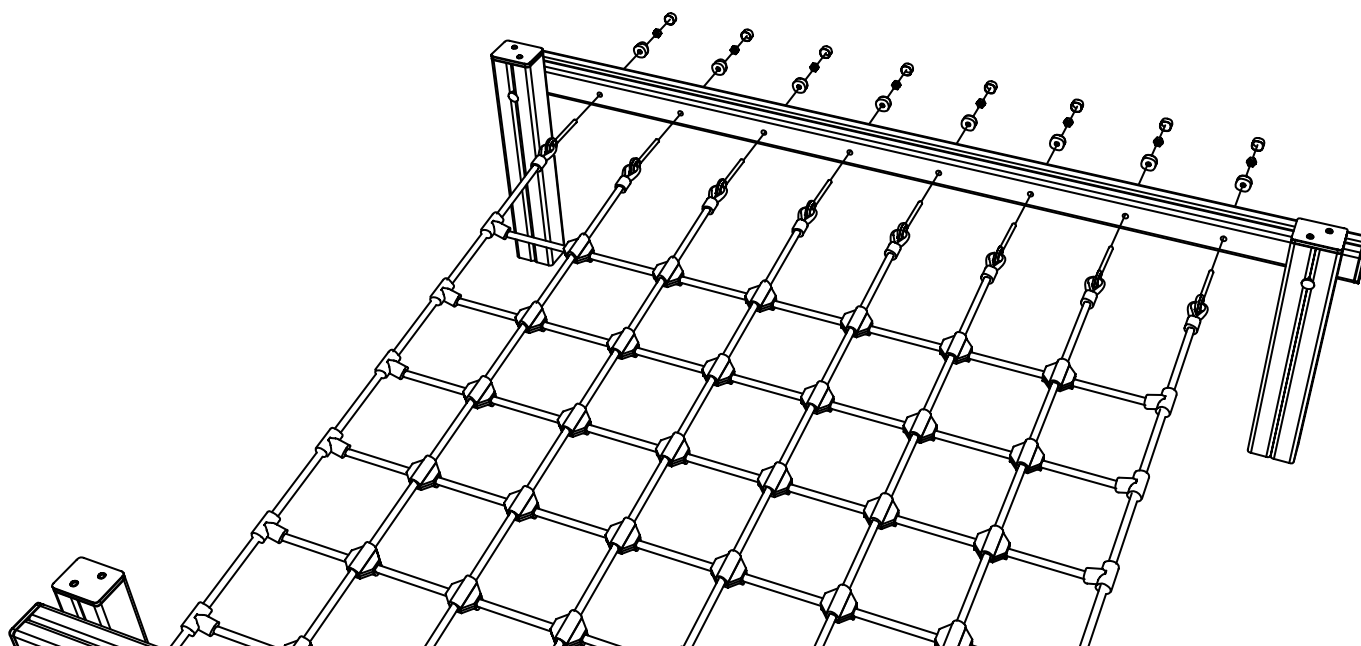

INSTALLATION INSTRUCTIONS

3 REPEAT FOR OPPOSITE SIDE ENSURING THE ROPES ARE TAUGHT

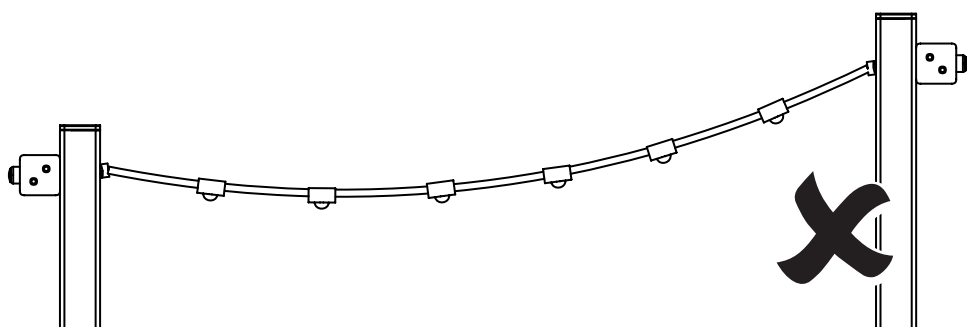
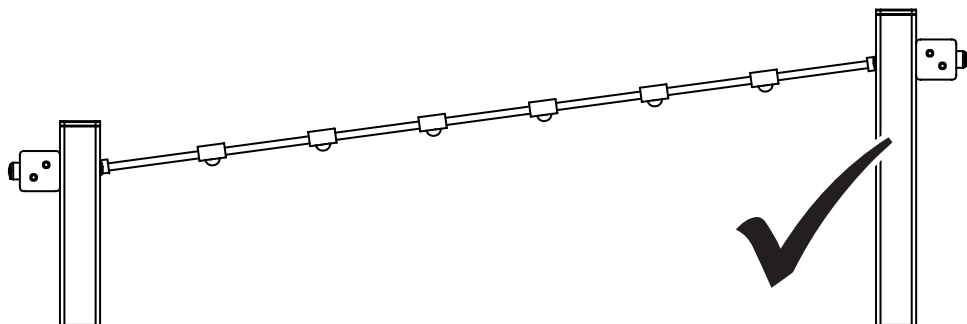

NOTES:
REPOSITION TIMBER FRAME
IF REQUIRED TO ENSURE NET
ASSEMBLY IS TAUGHT