

SWINGING LOG

Installation Instructions

**creative
play**

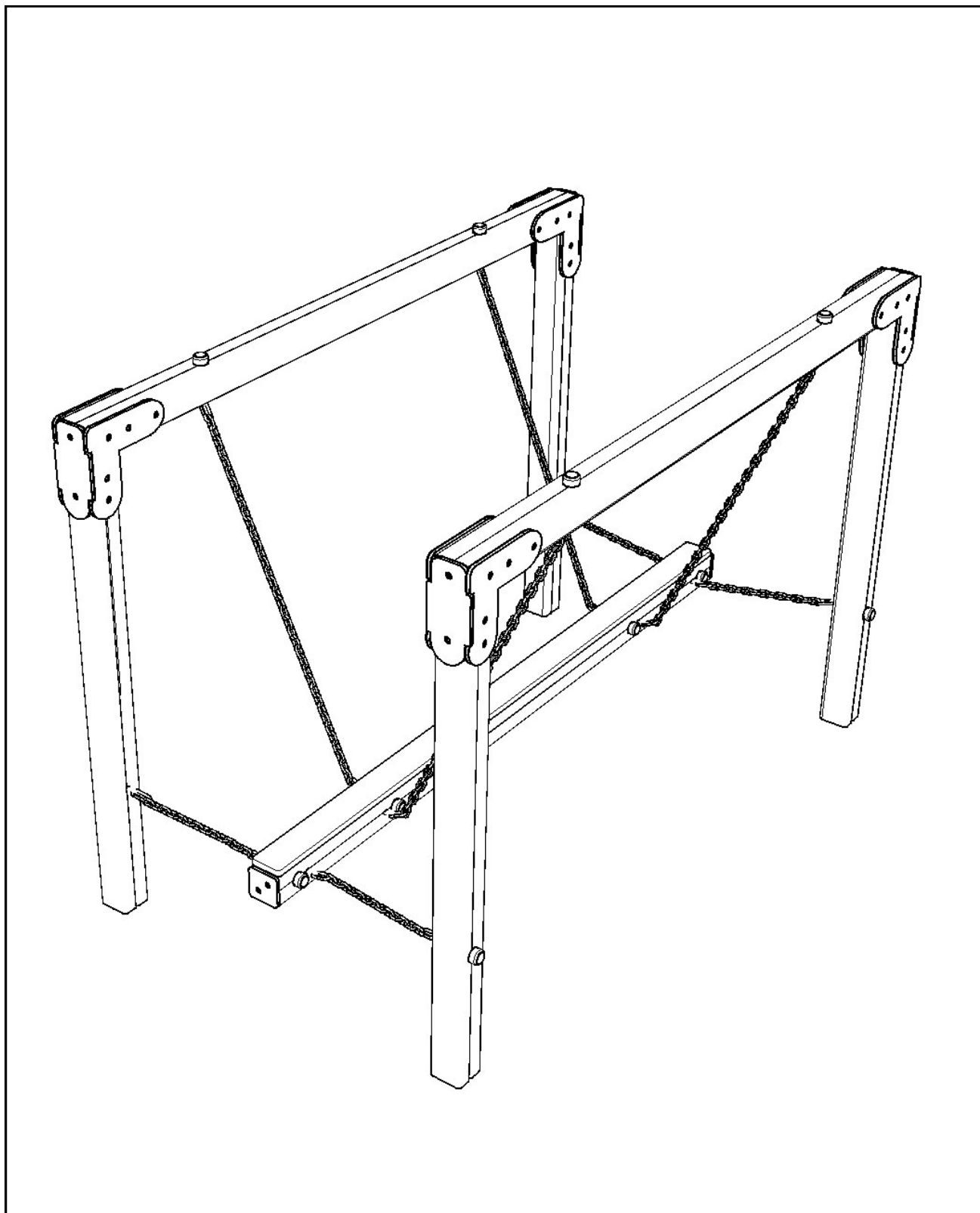

Parts required

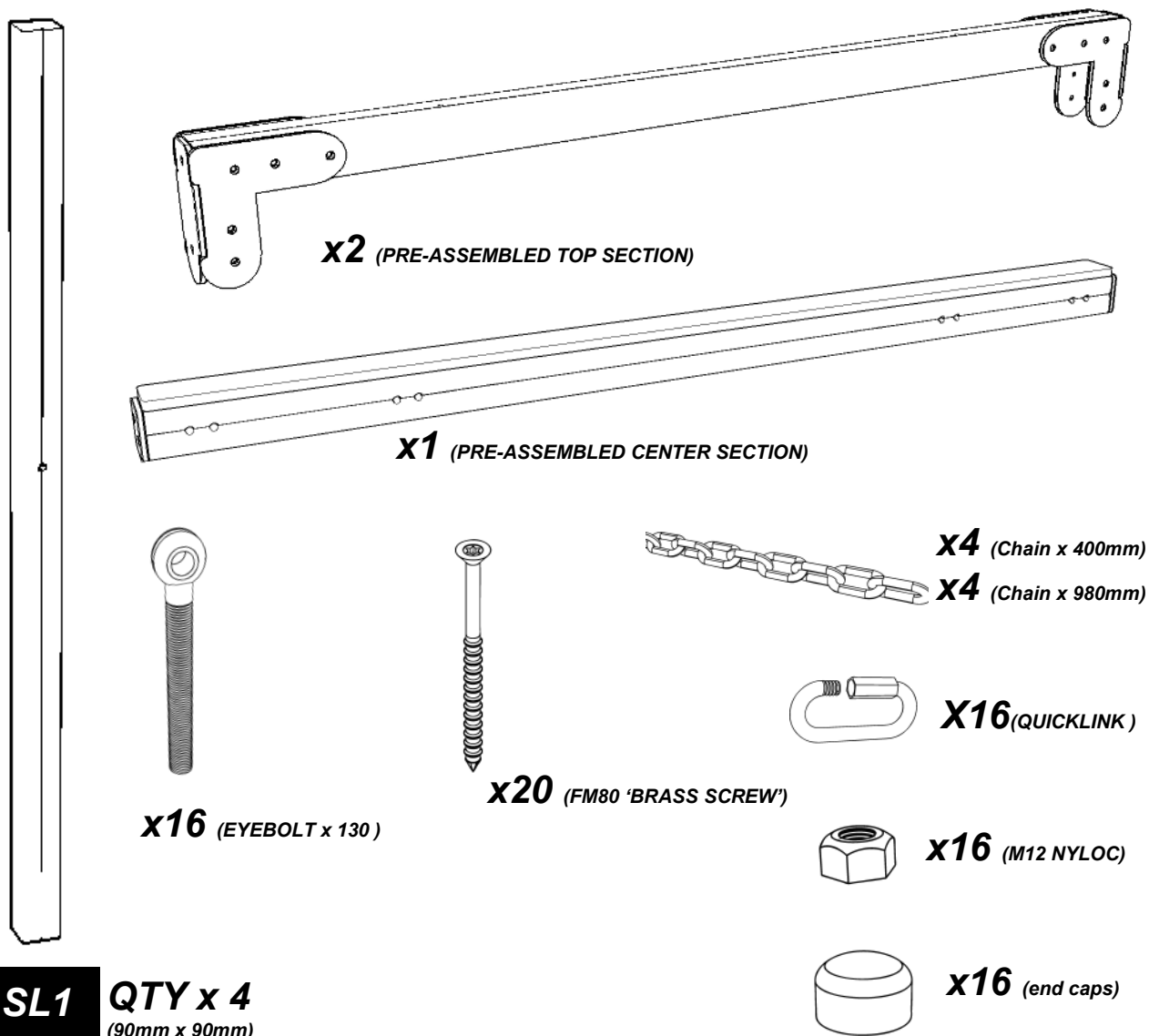

TOOLS required



Foundation details

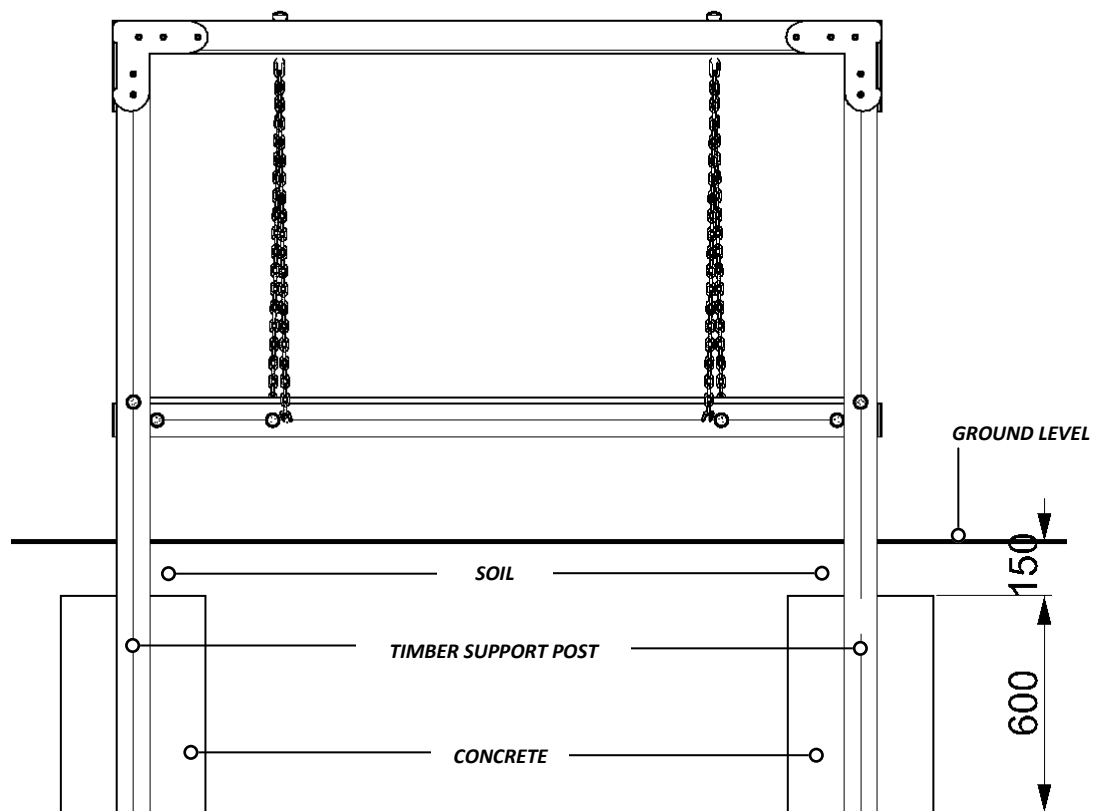
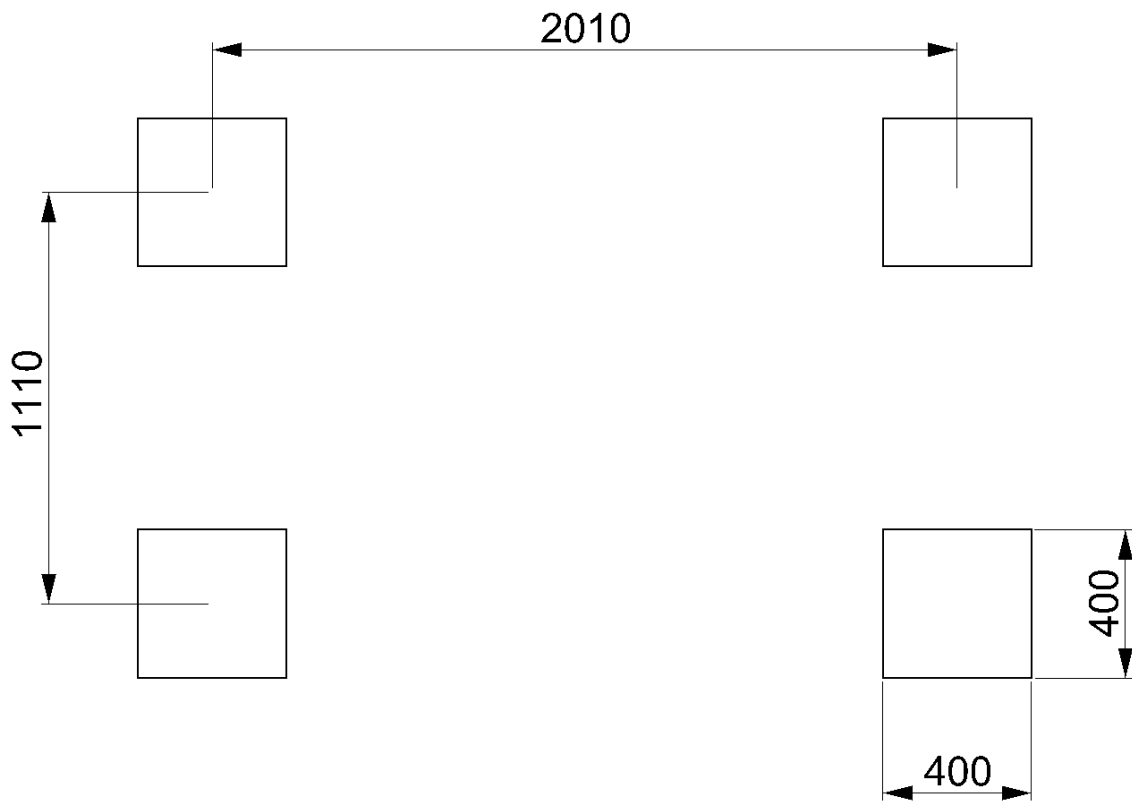

Surfacing details

- - - - - = MINIMUM SPACE
———— = SURFACING AREA

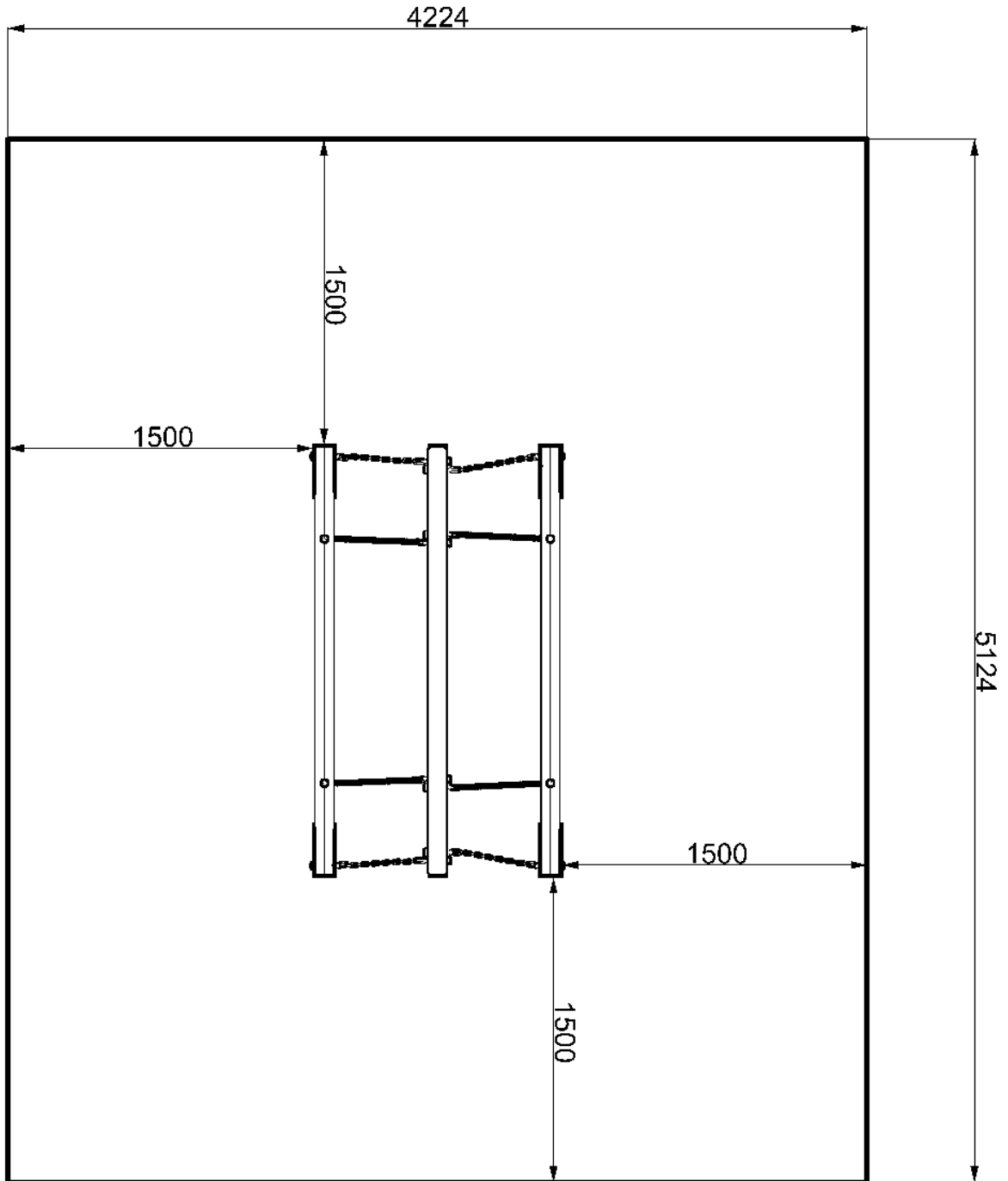

Assembly instructions

1

Install the timbers (SL1)

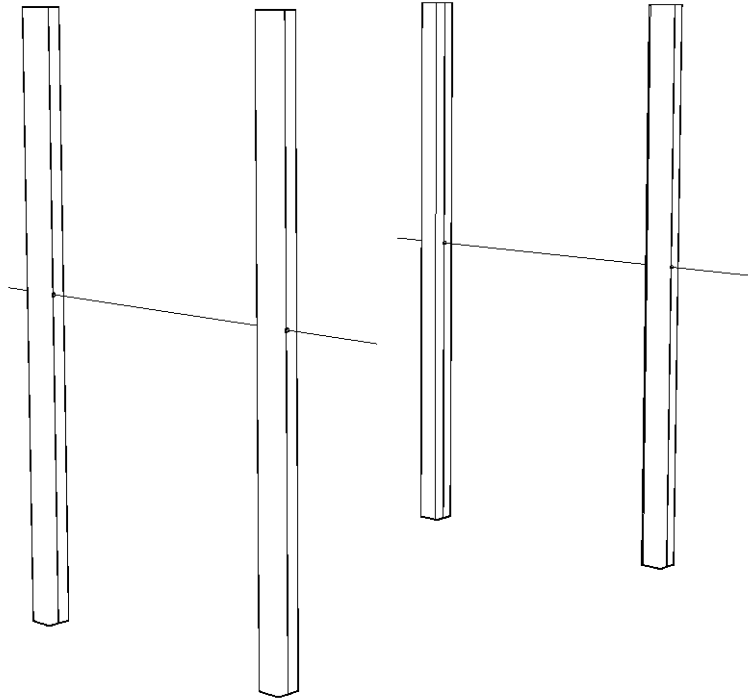

2

Attach the Eyebolt to the Timber (SL1)

Using NYLOCKS / END CAPS

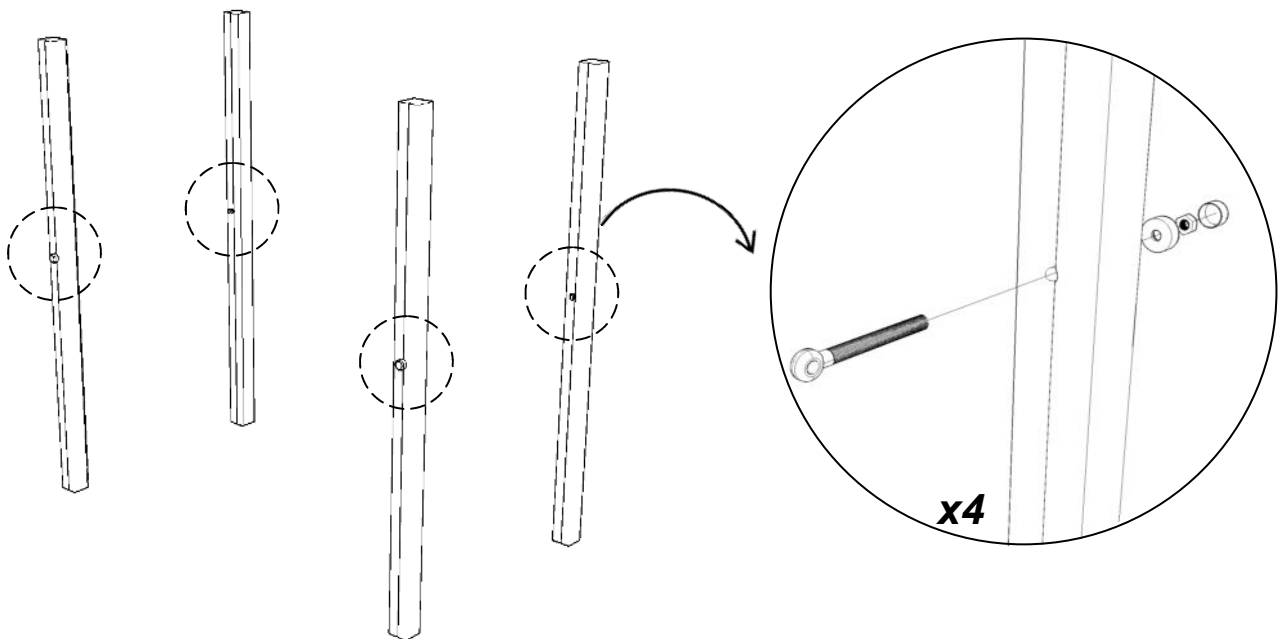

Assembly instructions

3

Attach the Eyebolt to the Timber (SL2)

Using NYLOCKS / END CAPS

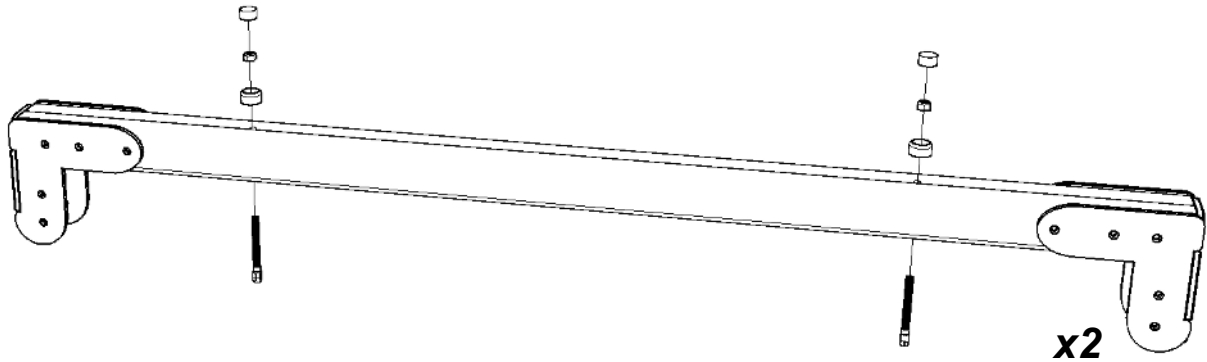

4

Attach the Eyebolt to the Timber (SL3)

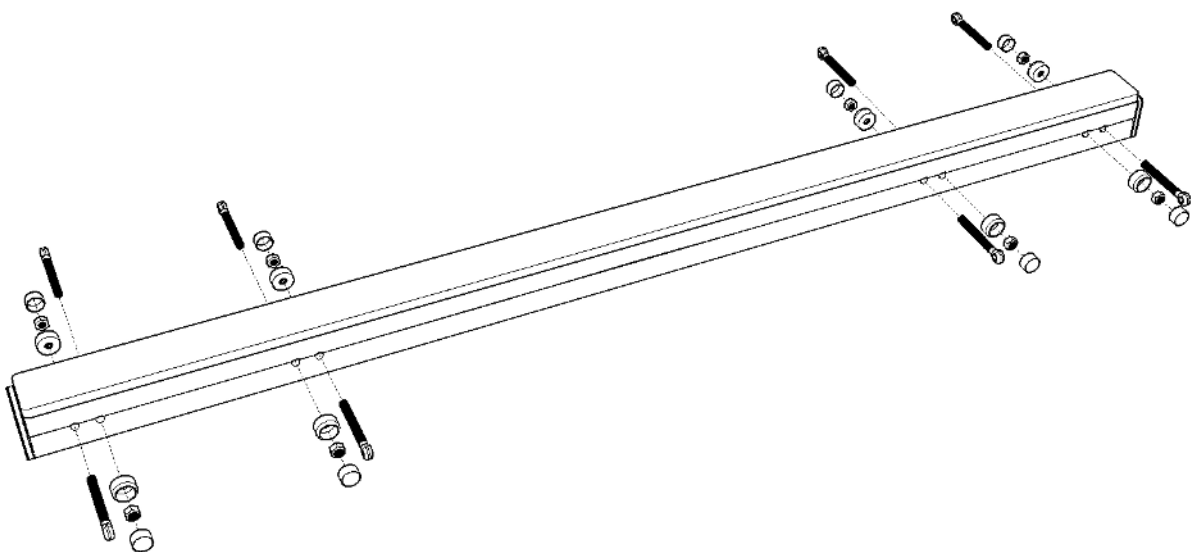

Assembly instructions

3

Attach the TOP PIECE to the Timber (SL1)

Using BRASS SCREWS

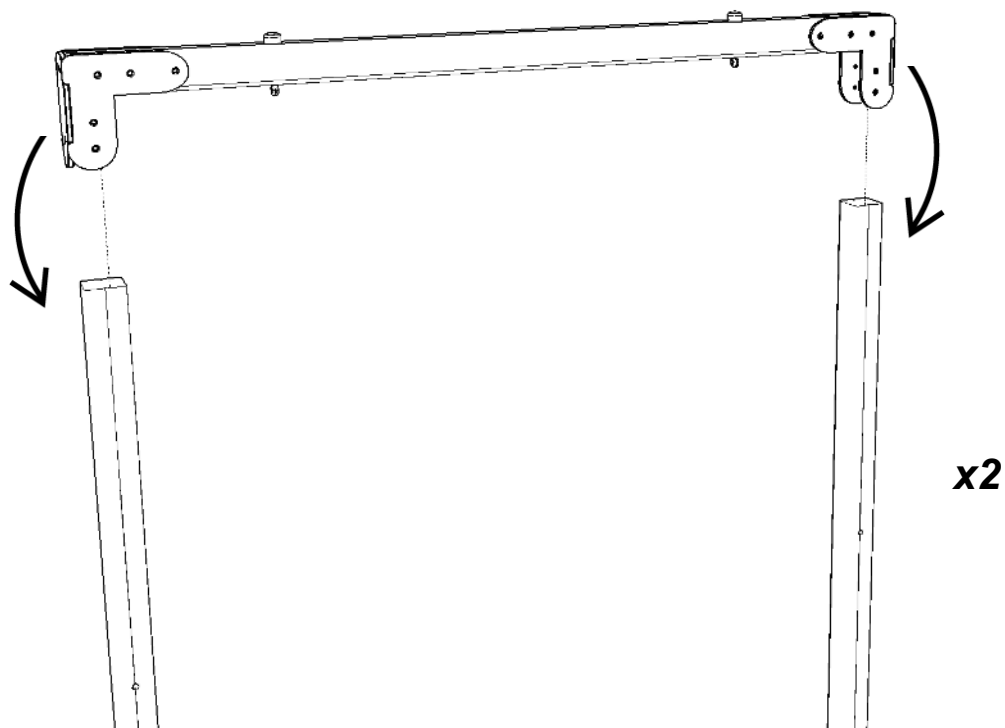

4

Attach the CHAIN to the EYEBOLTS using a QUICKLINK

Use LOCK TIGHT to ensure the quick link remains CLOSED

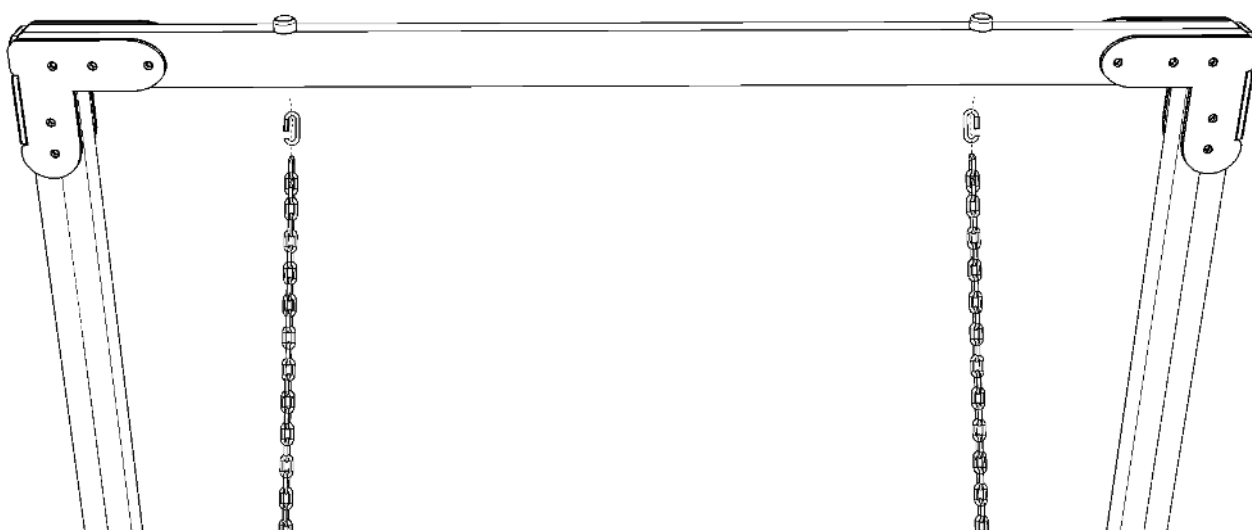

NOTES:

BOTH SIDES (980MM CHAIN)

Assembly instructions

4b

Attach the CHAIN to the EYEBOLTS using a QUICKLINK

Use **LOCK TIGHT** to ensure the quick link remains **CLOSED**

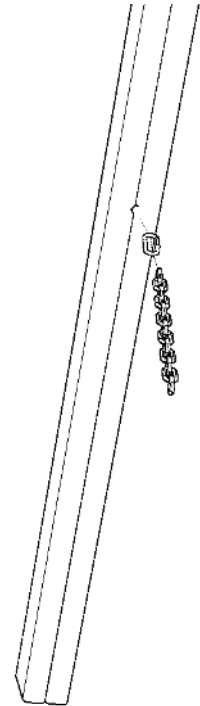

NOTES:

BOTH SIDES (400MM CHAIN)

4c

Attach the CHAIN to the EYEBOLTS using a QUICKLINK

Use **LOCK TIGHT** to ensure the quick link remains **CLOSED**

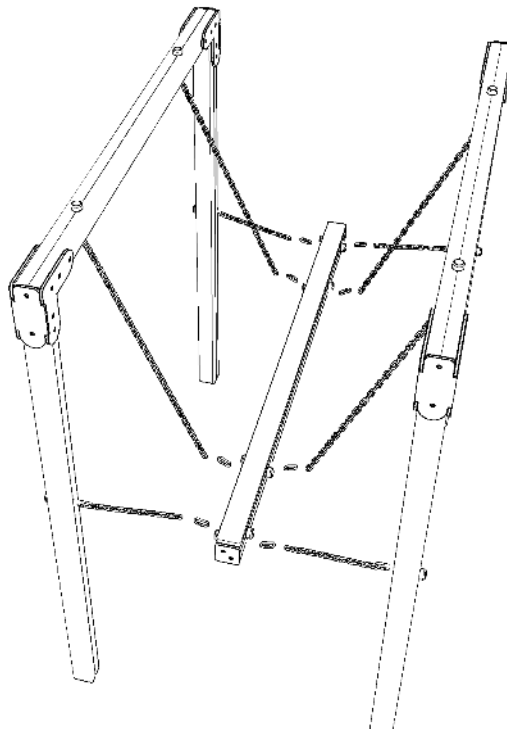

Additional dimensions

