

# **GYM206 - LEG RAISES - ADULT**

## ***Installation Instructions***

**creative  
play**

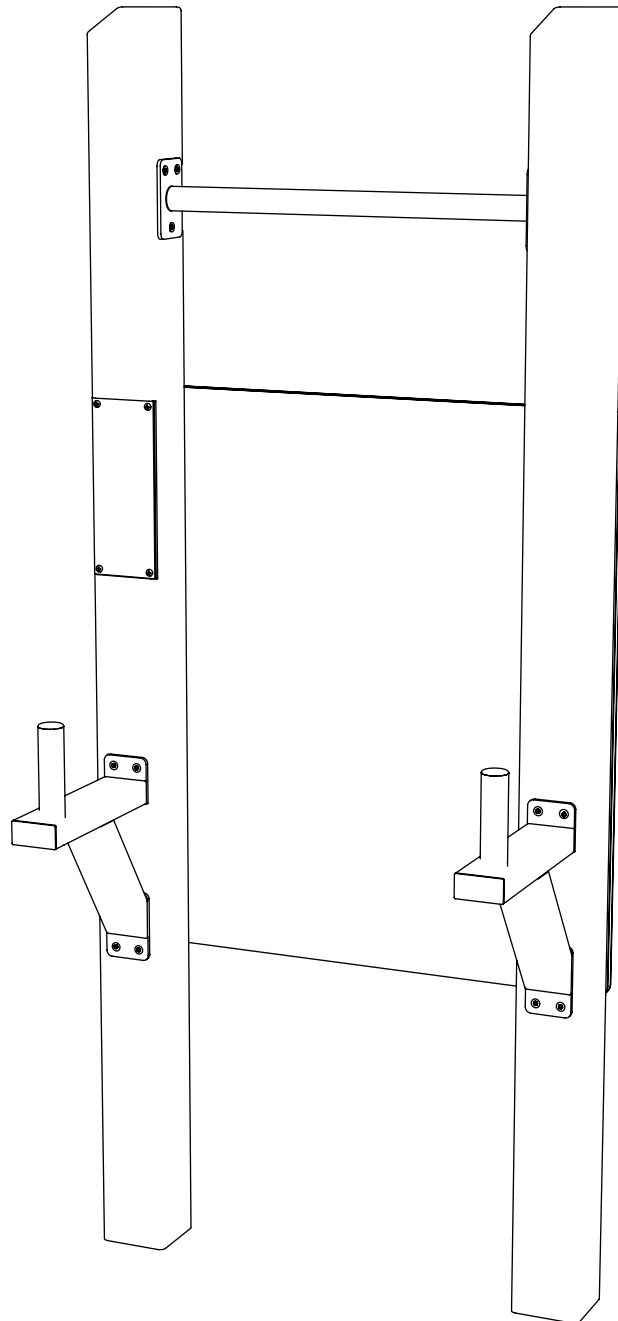

# ***PARTS REQUIRED***

---

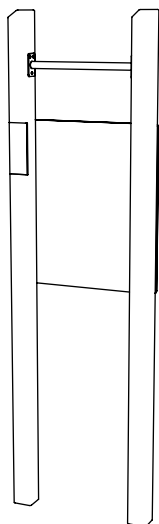

***PRE-ASSEMBLED PANEL***

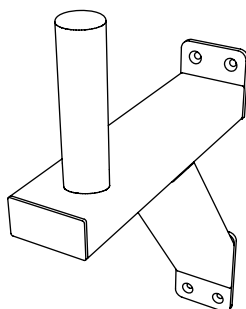

***LEG RAISE BAR [X2]***



***M8 X 80 SCREWS [X8]***

# ***TOOLS REQUIRED***

---

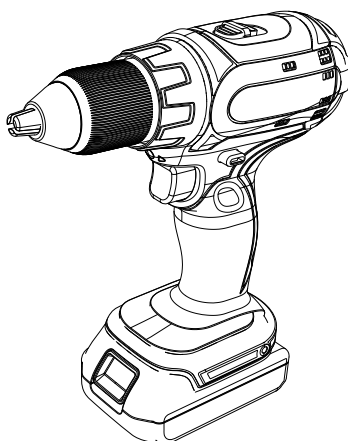
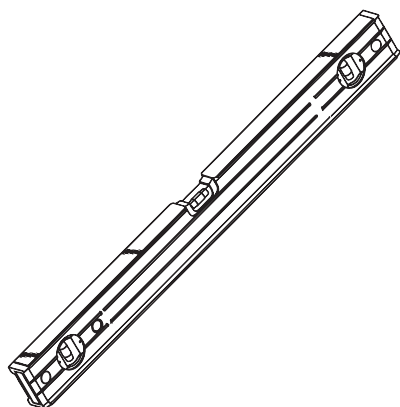

# FOUNDATION DETAIL

---

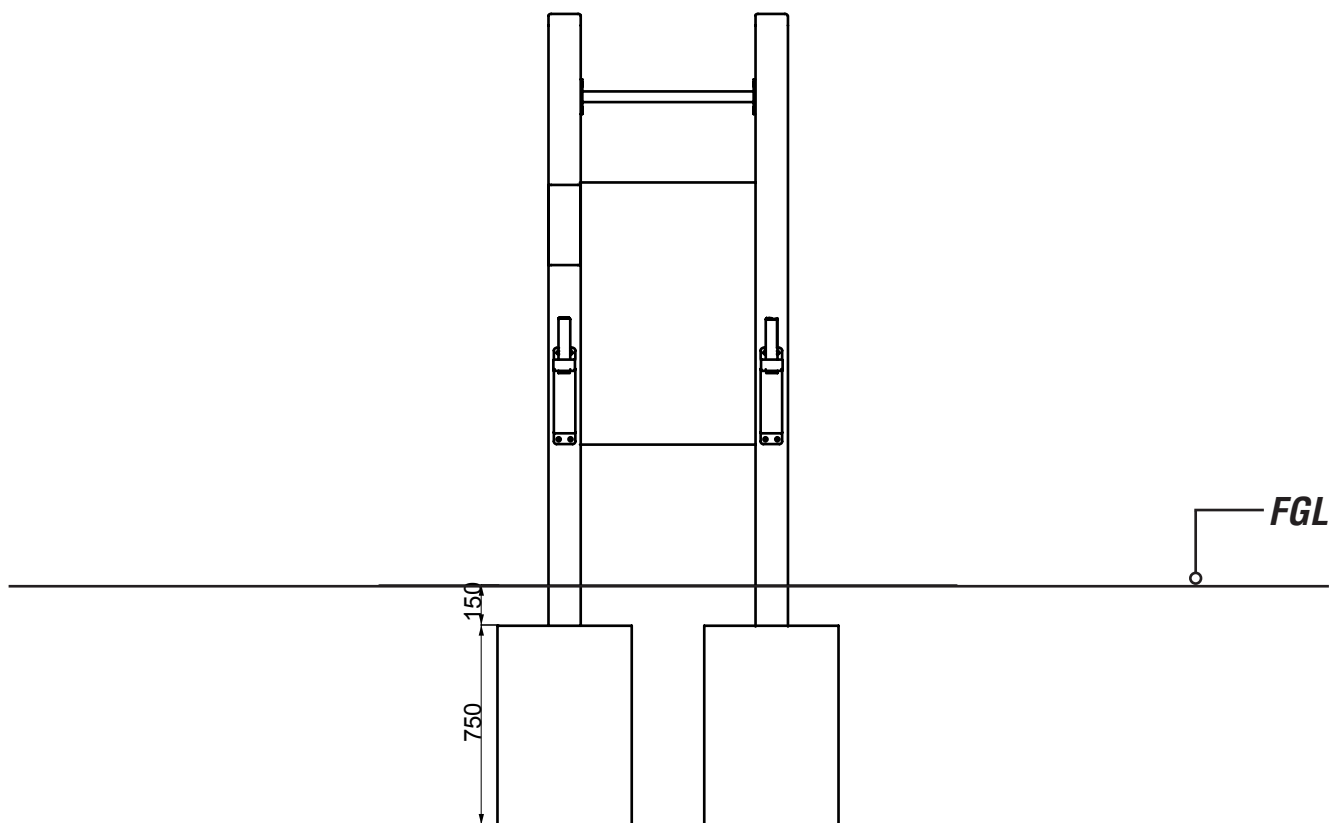
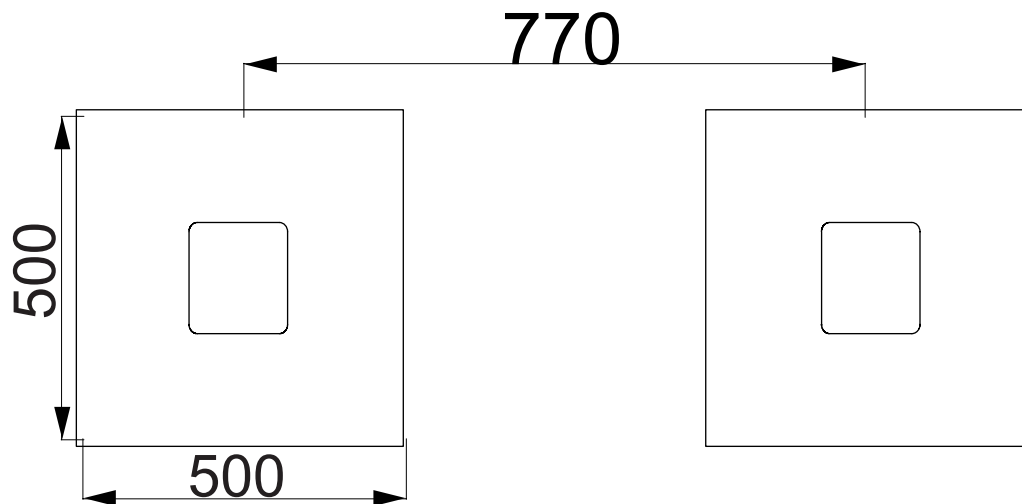

# ***SURFACING - OVERALL AREA***

---

**— = EN16630 STANDARD**

**— = EN11-76/77 STANDARD**

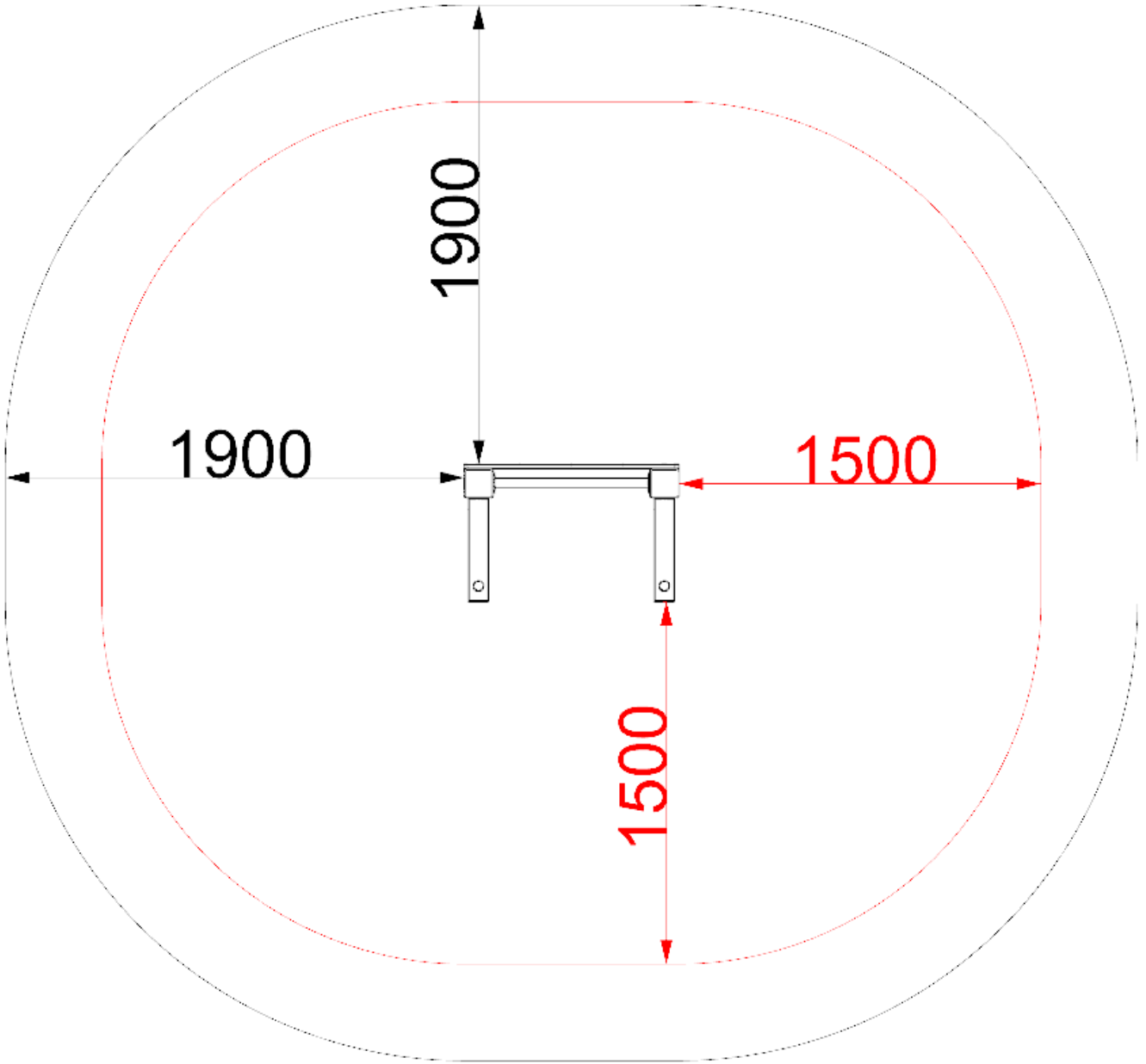

# INSTALLATION INSTRUCTIONS

---

**1**

**ATTACH LEG RAISE BARS TO PRE ASSEMBLED PANEL**

USING M8X80 SCREWS - BARS TO SIT LEVEL WITH BOTTOM OF SAFETEC

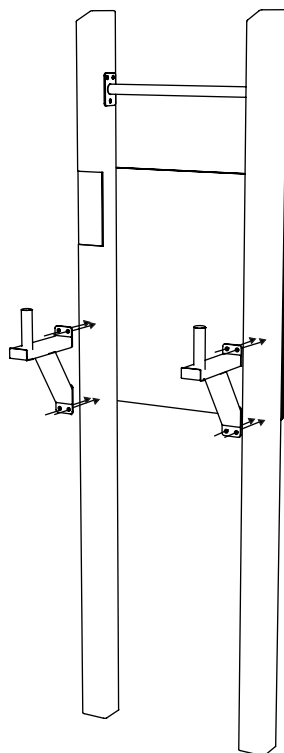

**2**

**INSTALL GYM206 INTO THE GROUND**

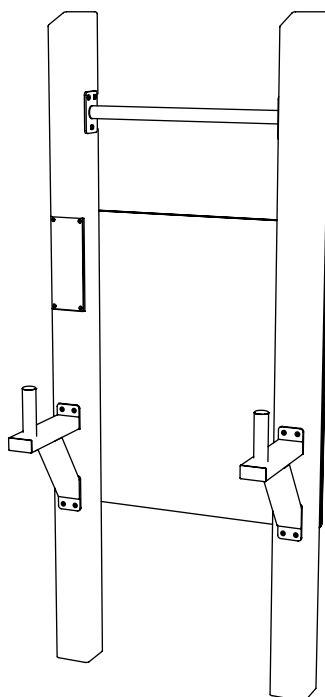

# ADDITIONAL MEASUREMENTS

---

